

RIVERSIDE ORCHARD TRACTS No. 2.

Being the W 1/2 of S.W. 1/4 of Section 19, Township 1 S, R. 39. E.W.M.

Know All men by These Presents; That C.R. Hibberd and Carrie L. Hibberd his wife, in consideration of the benefits to accrue and the approval of this plat, have platted the lands described in the accompanying plat into lots and the lots are of the dimensions and locations as indicated. Said lots shall be hereafter known as RIVERSIDE ORCHARD TRACTS Number 2. In witness whereof we have hereunto set our hands and seals on this the day of 1 1913.

Executed in presence of
J.R. Quinn
J.R. Quinn

C.R. Hibberd Seal
Carrie L. Hibberd Seal

State of Oregon }
County of Union } S.S.

Be it Remembered, that on this the 14th day of July 1913, before me, the undersigned a notary public, personally appeared C.R. Hibberd and Carrie L. Hibberd, his wife, personally known to me to be the identical persons described herein and who executed the foregoing instrument, and that they acknowledged to me that they executed the same freely and voluntarily.

In Witness Whereof, I have hereunto set my hand and notarial seal this, the day and year last above written.

J.R. Quinn
Notary Public for Oregon.

State of Oregon }
County of Union } S.S.

I, C.T. Darley, do hereby certify that I am County Surveyor of Union County, Oregon. That on day of July 1913, I surveyed the lands designated in the accompanying plat. That said survey is correctly made and platted. The initial point of said survey is

C.T. Darley
County Surveyor, Union Co. Oregon.

I, U.G. Couch, County Assessor of Union County, Oregon, do hereby certify that I have examined this PLAT and that all taxes and assessments are paid.

U.G. Couch
County Assessor.

Approved this the 5th day of Feb. 1914

J.L. Kenny County Judge
W.R. Halliday " "
J.P. Hutchinson " "

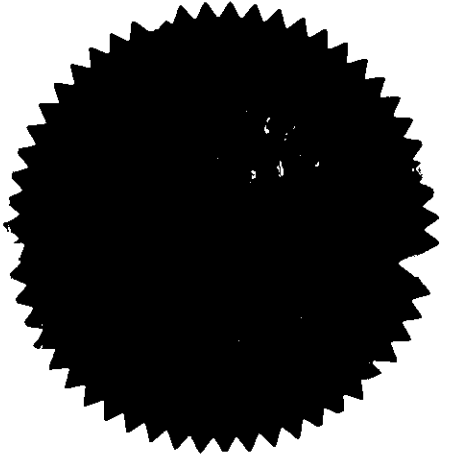
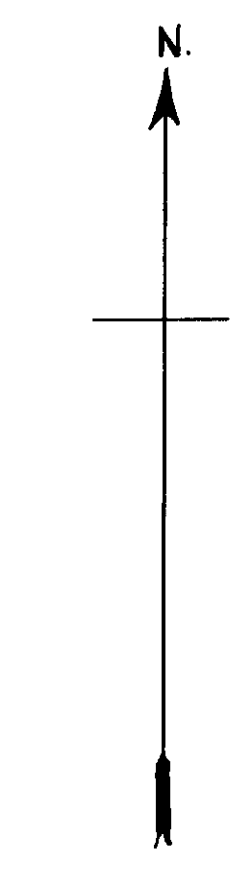
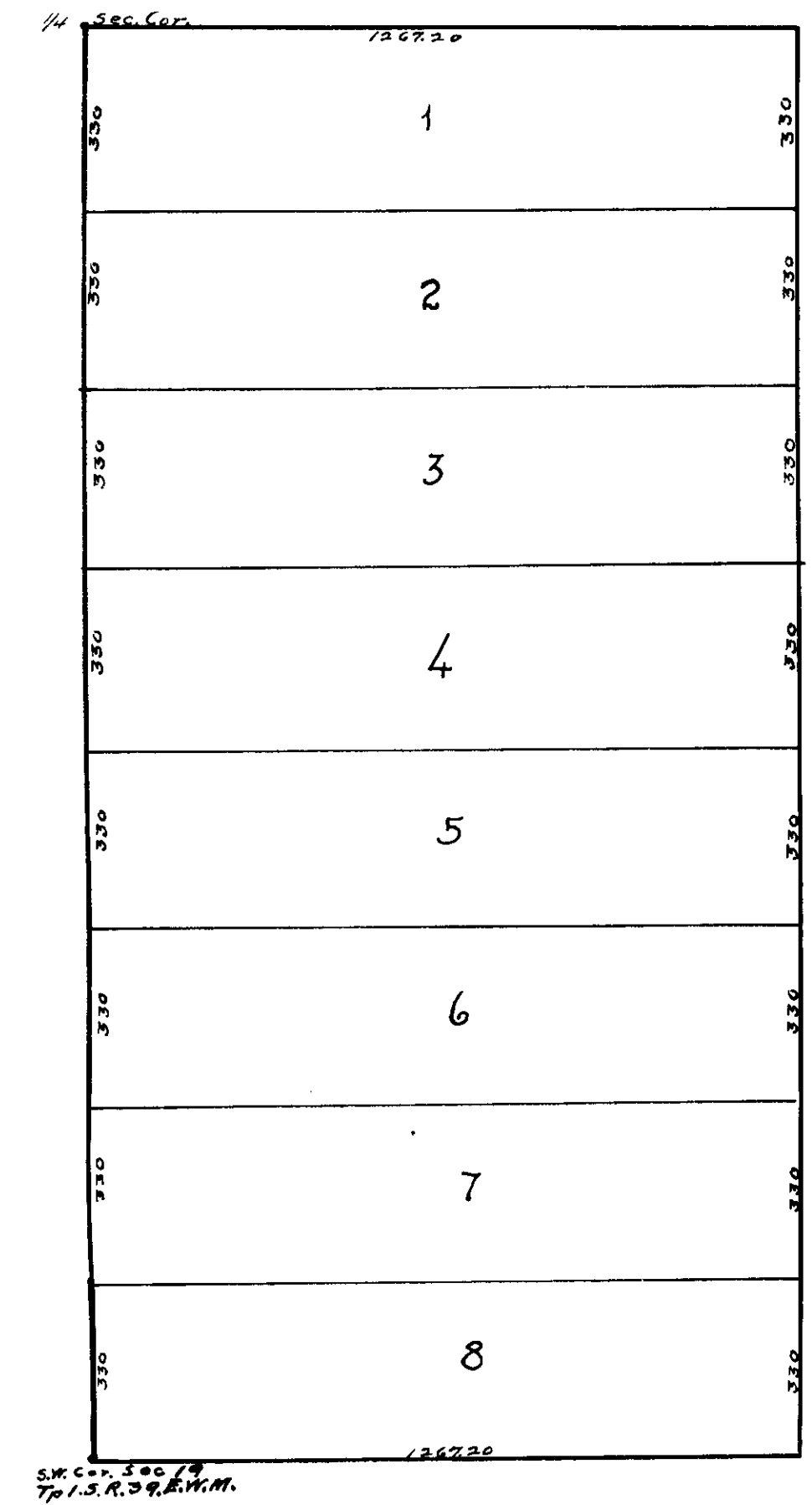

Recorded Feb 5 1914 by J.H. Ruster
County Recorder Union Co. Oreg.