

CLEARWATER POND

A Subdivision
 Located in the Northwest quarter
 of the Southwest quarter of Section 34,
 Township 2 South, Range 38 East
 of the Willamette Meridian

Sheet 1 of 2

LEGEND

- Set 2 1/2" x 30" Galvanized Iron Pipe with brass cap marked INITIAL POINT CLEARWATER POND SUBDIVISION 6" below the ground.
- Set 5/8"x30" IRON pin with plastic cap marked BGA SURVEY MARKER.
- Found 5/8" iron pin set by TELEK, filed as survey no. 57-73.
- Found 5/8"x30" iron pin with plastic cap marked TELEK set in concrete cylinder by survey no. 57-73
- Corner position by coordinate, no monument set.
- x- Existing fence line.
- - - Road centerline and center of section line.
- () Record bearing or distance as per Survey number 57-73.

BASIS OF BEARING

The forward bearing as published by the U.S.C. and G.S. from Δ College to Δ Valley, dated 1946..

FILING STATEMENTS

COUNTY RECORDING OFFICER 129390
 Filed this 6th day of April, 1989, at 3:20 P.M. on page 1 in Book A273 of Plats of Union County.
 County Recording Officer B. Nellie Bogue Hibbert, U.S. Clerk
 By Barbara C. Baker

STATEMENT OF WATER RIGHTS

I hereby certify that there are no appurtenant water rights to the above described property.

REGISTERED PROFESSIONAL LAND SURVEYOR
Gregory T. Blackman
 OREGON
 JULY 13, 1973
 GREGORY T. BLACKMAN
 991

129390

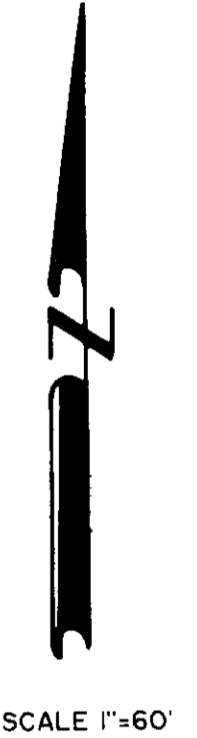

S.W. 1/16 Position located by coordinate, no monument set. See survey for R.D. Mac Inc. dated March 1989.

(S 0°00'45"E)
 S 0°01'04"E
 1328.24
 (1327.97)

S 1/16
 Found concrete cylinder with plastic cap marked Telek.

CLEARWATER POND

DEDICATION

Sheet 2 of 2

APPROVALS

STATE OF OREGON
SS
COUNTY OF UNION

This is to certify that R. D. MAC INCORPORATED is a corporation duly organized and existing under and by virtue of the laws of the State of Oregon, and is the owner of the land described in the annexed surveyors certificate, said lands to be hereafter known as CLEARWATER POND; that said R. D. MAC INCORPORATED did cause the same to be surveyed and platted as shown on the annexed map and we do for ourselves, our heirs and assigns, hereby dedicate, donate and convey to the public use forever, all

roads as shown; said plat being subject to utility, and ingress and egress easements as shown on the annexed plat.

In witness whereof, R. D. MAC INCORPORATED, pursuant to a resolution of its board of directors, duly and legally adopted, has caused these presents to be signed by its president and secretary and its corporate seal affixed hereto.

Harry T. Collman
Harry T. Collman President

Carole R. Peek
Carole R. Peek Secretary



STATE OF OREGON
SS
COUNTY OF UNION

Be it remembered that on this 29th day of March, 1989, personally appeared before me Harry T. Collman, president and Carole R. Peek, secretary, of R. D. MAC INCORPORATED, who are known to me to be the identical persons described herein and who executed the above instrument, and who acknowledged to me that they executed

the same freely and voluntarily as such officers on behalf of said corporation by authority of its board of directors. In witness whereof, I have hereunto set my hand and affixed my official notary seal this 29th day of March, 1989.

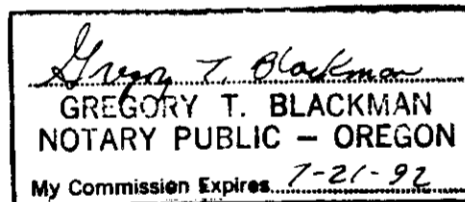

Subscribed and sworn before me this 29th day of March, 1989

Gregory T. Blackman
NOTARY PUBLIC OF OREGON

My commission expires 7-21-92

SURVEYOR'S CERTIFICATE

STATE OF OREGON
SS
COUNTY OF UNION

I Gregory T. Blackman, surveyor, being duly sworn, depose and say that I have surveyed, subdivided and platted CLEARWATER POND, situated in the Northwest Quarter of the Southwest Quarter of Section 34, Township 2 South, Range 38 East of the Willamette Meridian. More particularly described as follows:
Beginning at a 2 1/2" x 36" galvanized iron pipe, with brass cap marked "INITIAL POINT - CLEARWATER POND SUBDIVISION", said point being 18.62 feet South and 1291.41 feet East of the West 1/4 corner of Section 34,

Thence: S 0°32'48" W, 250.00 Feet;
Thence: S 89°56'20" W, 759.50 Feet;

Thence: S 0°32'48" W, 450.00 FEET;
Thence: S 89°56'20" W, 135.00 Feet;
Thence: N 0°32'48" E, 720.00 Feet;
Thence: N 89°56'20" E, 894.50 Feet;
Thence: S 0°32'48" W, 20.00 Feet to the point of beginning, said parcel containing 6.94 acres; and that I made such survey and plat by order of and under direction of the owners thereof; that the size of all lots and the width of the roads are as shown on the annexed plat; and that all interior and exterior lot corners are marked with iron pins as indicated on the annexed plat all in accordance with ORS. 92.060.

Gregory T. Blackman
SURVEYOR L. S. 991

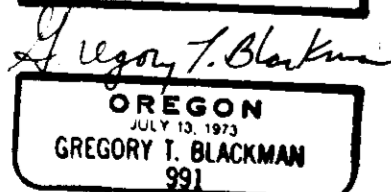
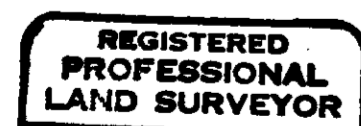

Subscribed and sworn before me this 15th day of MARCH, 1989

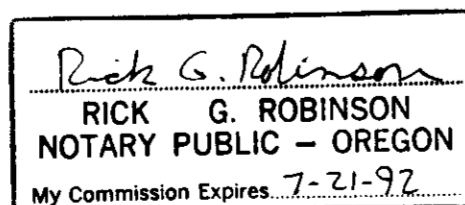

Rick G. Robinson
NOTARY PUBLIC OF OREGON

My commission expires 7-21-92

UNION COUNTY PLANNING COMMISSION

Approved this 5 day of April, 1989.

Jeffrey B. Wilson - Chairman

UNION COUNTY SURVEYOR

Examined and recommended for approval by the UNION COUNTY BOARD of COMMISSIONERS this 29 day of March, 1989.

Howard L. Derry

UNION COUNTY COURT

Approved this 5 day of April, 1989.

John J. Howard - Judge

Marie C. Foster
Conner R. Savage - Commissioner

UNION COUNTY ASSESSOR

I hereby certify that pursuant to ORS 92.095, all AD VALORUM TAXES and all special assessments, fees and other charges required by law to be placed on the tax roll which became a lien on this subdivision or will become a lien during this calendar year but not yet certified to the tax collector for collection, have been paid to me.

Date April 9, 1989 Assessor
By Marcia L. Peterson, Chief Deputy

UNION COUNTY TREASURER

I hereby certify that all AD VALOREM TAXES and all special assessments, fees and other charges required by law to be placed upon the tax roll which have become a lien on this subdivision and that now are due and payable have been paid.

Date April 4, 1989 Treasurer
By Peggy Sutton

A272