

BE IT REMEMBERED, That at a regular term of the County Court of the State of Oregon, for the County of Union, sitting for the transaction of County business, begun and held at the Court House in the City of La Grande, in said County and State, on Wednesday, the 1st day of July, A. D., 1914, the same being the first Wednesday of said month and the time fixed by law for holding a regular term of said Court, when were present:

- The Honorable J. C. Henry, County Judge,
- C.A. Galloway, Commissioner,
- J.F. Hutchinson, Commissioner,
- Ed Wright, Clerk,
- August Hug, Sheriff.

WHEN, on Thursday, the 2nd day of July, A. D. 1914, or the 2nd Judicial Day of said term, among others the following proceedings were had, to-wit:

In the matter of the proposed county road petitioned for by J. B. Thomson et al.

71430

WHEREAS, a petition has been filed in this court requesting that a county road be laid out along the following route, to-wit:

Beginning at a point on the county road between Union and Medical Springs about 20 rods east of the west section corner common to Sections 16 and 21, where the wagon road heretofore used as such branches from said regular county road leading from Union to Medical Springs, township 5 south, range 41 E.W.M. in road district No. 8, thence along the line of the old road up Catherine Creek a distance of about one-half mile where such road crosses a bridge; thence continuing along said old road up Catherine Creek a distance of three quarters of a mile further to the section line between sections 21 and 22, township 5 south, range 41 East to what is known commonly as the Thompson Place or Summer Resort.

AND, WHEREAS, the laying out and establishment of the road as above described is considered of public necessity.

Therefore, BE IT RESOLVED, that the County Surveyor be and he is hereby ordered and directed to make an examination of the proposed route of said road as provided by law.

(Signed) J.C. Henry, County Judge
C.A. Galloway, Commissioner
J.F. Hutchinson, Commissioner

Faint, illegible text, possibly bleed-through from the reverse side of the page.

J. B. Thompson

Additional faint, illegible text, possibly bleed-through from the reverse side of the page.

BE IT REMEMBERED, That at a regular term of the County Court of the State of Oregon, for the County of Union, sitting for the transaction of County business, begun and held at the Court House in the City of La Grande, in said County and State, on Wednesday, the 2nd day of September, A. D., 1914, the same being the first Wednesday of said month and the time fixed by law for holding a regular term of said Court, when were present:

The Honorable J. C. Henry, County Judge,
C.A.Galloway, Commissioner,
J.F.Hutchinson, Commissioner,
Ed Wright, Clerk,
August Hug, Sheriff.

WHEN, on Thursday, the 3rd day of September, A. D. 1914, or the 2nd Judicial Day of said term, among others the following proceedings were had, to-wit:

In the matter of the proposed
County road petitioned for by
J. B. Thomson et al

77453

Now at this time this matter came on for hearing upon the report of the County Surveyor, and it appearing to the court that the said County Surveyor has made a favorable report, and it appearing to the court from said report of the County Surveyor that said road will be of utility and convenience to individuals and the public.

It is therefore CONSIDERED and ORDERED that the County Surveyor be and he is hereby directed to make a survey and plat of said proposed road and report to this court before the first day of the next term.

(Signed) J.C.Henry, County Judge
C.A.Galloway, Commissioner
J.F.Hutchinson, Commissioner.

J B Thomson

BE IT REMEMBERED, That at a regular term of the County Court of the State of Oregon, for the County of Union, sitting for the transaction of County business, begun and held at the Court House in the City of La Grande, in said County and State, on Wednesday, the 4th day of November, A. D., 1914, the same being the first Wednesday of said month and the time fixed by law for holding a regular term of said Court, when were present:

The Honorable J.W.Knowles, County Judge,
C.A.Galloway, Commissioner,
J.F.Hutchinson, Commissioner,
Ed Wright, Clerk,
August Hug, Sheriff.

WHEN, on Thursday, the 5th day of November, A. D. 1914, or the 2nd Judicial Day of said term, among others the following proceedings were had, to-wit:

In the matter of the proposed County road petitioned for by J. B. Thomson et al.

N. 471

Now at thistime this petition came on for final hearing upon the report of the County Surveyor, and it appearing to the court that said County Surveyor has filed in writing his report recommending that the prayer of the petitioners be granted and that an actual survey of the same be made and plat thereof filed, and there being no remonstrance filed nor claim for damages.

It is therefore CONSIDERED and ORDERED that said petition be and the same is hereby granted and said road declared to be and established as a county road on the following line or route, to-wit:

Beginning at a point on the county road between Union and Medical Springs about 20 rods east of the west section corner common to sections 16 and 21, where the wagon road heretofore used as such, branches from said regular county road leading from Union to Medical Springs, township 5 South, Range 41 E.W.M. in road district No. 8, thence along the line of the old road up Catherine Creek a distance of about one-half mile where such road crosses a bridge; thence continuing along said old road up Catherine Creek a distance of three quarters of a mile further, to the section line between sections 21 and 22, township 5 south, Range 41 East to what is known commonly as the Thompson Place or Summer Resort.

(Signed) J.C.Henry, County Judge
C.A.Galloway, Commissioner
J.F.Hutchinson, Commissioner.

To the Hon. County Court
of
Union County, Oregon.

In the matter of the survey of thr County Road as petitioned for by J. B. Thompson et al, I beg leave to report that I have surveyed the same and marked it, and find that by crossing the creek at the old crossing or bridge it will not do any material damage to the abutting property owners and that the present bridge be moved to that site.

The following being the field notes and plat of said road attached:

Commencing at a point 12.42 Chains east of NW Cor of Sec 21 Twon 5
S R 41 E W M

Thence South 78 deg 00' East
Chains
12.74 to Angle 1 a tree; Thence South 41 deg East ✓
6.66 " 2 a stump " North 80deg " ✓
8.00 " 3 a tree " " 32 deg " ✓
1.50 " Catherine Creek at ~~point~~ point at Old Bridge North 32 deg East
1.50 to Angle 4 a tree Thence South 82 Deg east ✓
6.60 " 5 " " " 70deg 30' East ✓
8.25 " 6 " " " 56 deg "
8.33 " 7 " " " 71 deg "
6.06 " 8 " " " 37 deg "
5.09 " 9 " " " 85 deg "
7.37 to road Terminus at point 12.88 Chains South of SE Cor of N.E. $\frac{1}{4}$
Section 21 Twp. 7 South R. 41. E. W. M.

Respectfully submitted

Arthur Curtis
County Surveyor

Road. Petitioned for by J. B. Thompson, et. al.

Township 5 South Range 41 East W. M.

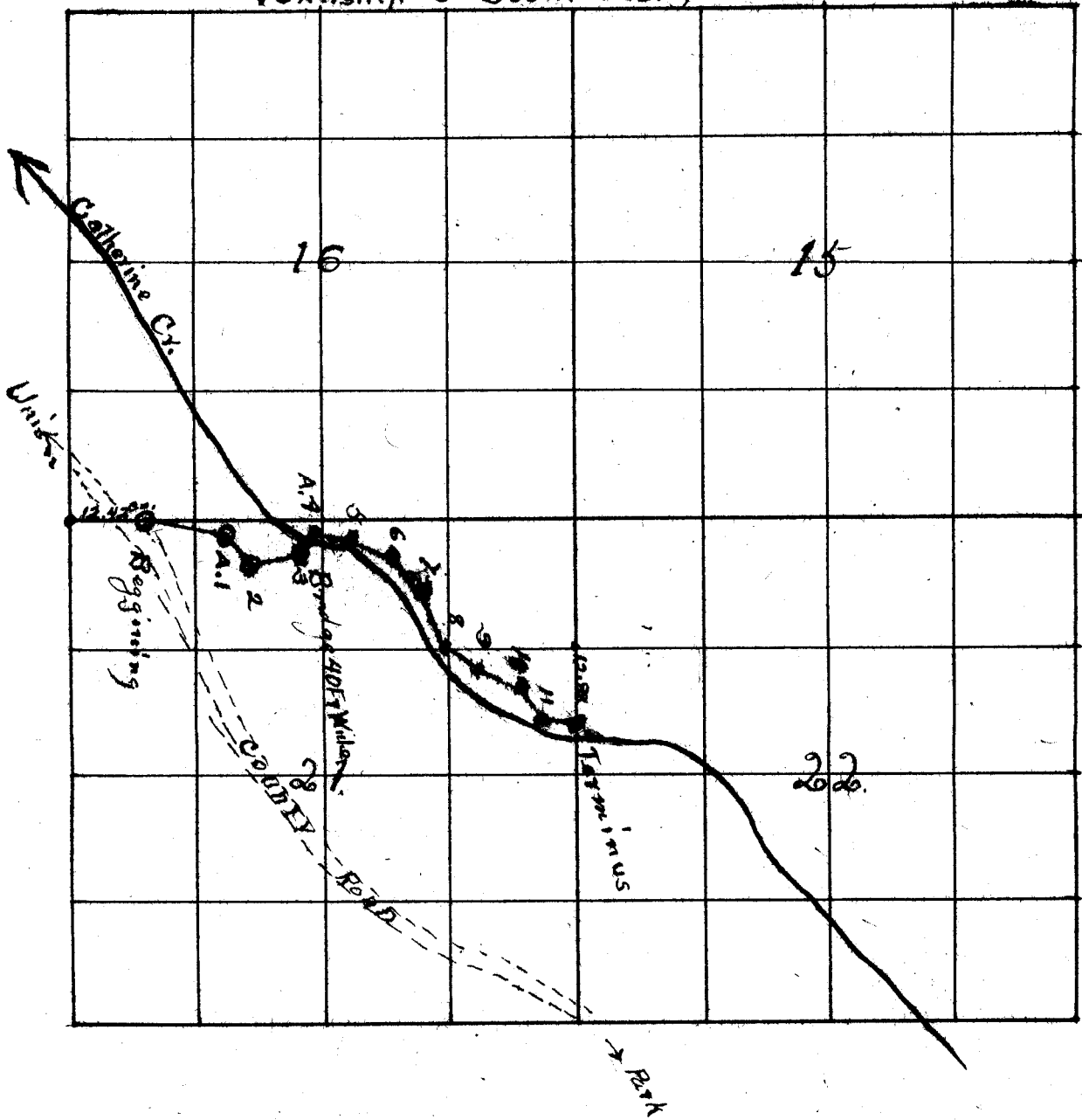

To the Hon. County Court
of Union County, Oregon.

To your Hon. Body:

I, Arthur Curtis, who was appointed to investigate the proposed county road as petitioned for by J. B. Thompson and others, beg leave to report as follows:-

That I went over said road for the whole distance thereof and find that the grade is good or only water grade, and that said road will only require one bridge across Catherine Creek and that there is a bridge across said creek but not in the proper place to do the least damage to the property owners according to the amount of benefit to be derived from same.

I therefore recomend that the petition of the petitioners be granted and that an actual survey of said road, and that said road be built along said line of survey, and that they do not follow said road for the entire distance as now traveled and been traveled for ten (10) years or more.

Yours respectfully,

-----*Arthur Curtis*-----

County Surveyor

an order that the County Survey be made

Petition for County Road

To the Honorable County Court, for Union County, Oregon:

The undersigned freeholders, of Union County, Oregon, residing in the Road District where the hereinafter described road is proposed to be, respectfully petition your honorable body to lay out, alter and establish a County Road within said county, on the following line or route, to-wit:

Beginning at a point on the County Road between Union and Medical Springs about 20 rods East of the West Section corner common to sections 16 and 21, where the wagon road heretofore used as such branches from said regular County road leading from Union to Medical Springs, township 5 South, Range 41 E. W. M. in road district No. 8, thence along the line of the old road up Catherine Creek a distance of about one-half mile.... where such road crosses a bridge; thence continuing along said old road up Catherine Creek a distance of three quarters of a mile further, to the section line between sections 21 and 22, township 5 South, Range 41 East to what is know commonly as the Thompson Place or Summer Resort.....

And in duty bound, your petitioners will ever pray, &c.

NAMES:

J. B. Thayer
 J. B. Vander
 S. V. Cannon
 H. J. Stevens
 William Reynolds
 Joseph C. Fay
 E. J. Vander Venter
 R. M. Dwyer
 G. M. South
 Durham Wright
 F. J. Miller
 J. C. Carr
 J. H. Powers
 L. A. Wilson
 M. E. Wilson
 R. E. Johnson
 S. J. Smith
 R. S. Beach

NAMES:

William K. Hobbs
 Lyman Wright
 J. B. Martin
 J. J. Turner
 J. M. Galt
 J. N. Gay
 J. P. Pugh
 W. C. Anderson

IN THE
COUNTY COURT
FOR THE
STATE OF OREGON
FOR
UNION COUNTY

In the matter of the

John Bond

for by

J. W. Johnson

Patton

FILED

1914

James
Carroll
Clerk

Deputy

Notice of Road Petition

TO ALL PERSONS CONCERNED You and each and all of you, will take notice that the undersigned freeholders of Union county Oregon, residing in the road district where the hereinafter described road is proposed to be, will at the next session of the County Court for Union county, Oregon, to-wit on Wednesday, the 3rd day of JUNE A D 1914 respectfully present to said court a petition praying said court to lay out, alter and establish a County Road within said county on the following line, or route, to-wit

Beginning at a point on the County Road between Union and Medical Springs about 20 feet east of the West section corner common to sections 16 and 21, where the wagon road heretofore used as such, branches from said regular County road leading from Union to Medical Springs Township South, Range 11 W N, in section 11 tract No 8 thence along the line of the old road up Catherine Creek a distance of about one-half mile where such road crosses a bridge; thence continuing along said old road up Catherine Creek a distance of three quarters of a mile further, to the section line between sections 21 and 22, Township 5 South Range 11 East, to what is known commonly as the Thompson Place or Summer Resort

Dated at Union Oregon, the 29 day of April A D 1914

NAMES

NAMES

J. B. Harrison
J. B. Warrick
J. J. Warrick
Wm. J. Warrick
William P. Warrick
Joseph L. Gray
W. M. Simpson
G. M. South
Dennis W. Wright
J. M. Miller
L. O. Cox
J. H. Powers
Lee A. Johnson
W. H. Wilson
W. J. Smith
A. H. White

William K. Goble
Wm. W. Goble
J. B. Warrick
J. J. Warrick
Wm. J. Warrick
J. H. Powers
Lee A. Johnson
W. H. Wilson
W. J. Smith
A. H. White

J. P. King
Wm. Warrick

In the County Court For Union County, State of Oregon
In the Matter Of Petition Of) Proof of Notice
County Road)
-----)

J. B. Thompson being first duly sworn deposes and says :
That he is one of the petitioners for a county road as described
in the hereunto^{attached} notice of County road and the hereunto attached pe-
tition for said county road also described in said petition.

That said Notice is signed by the same parties as have
signed the said hereunto attached petition and that this affiant
herein is one of your petitioners for said described county road
as described as aforesaid in both said petition and Notice of County
road.

Affiant says that he posted said notices and copies of same
in three public places along and in the vicinity of said proposed
county road to wit: one of said notices was posted at the begin-
ning of said proposed road where the same leaves the county road
running from Union to Medical Springs Oregon, on a tree ; one of
said notices at the other end of said proposed road on the gate
leading to the place owned by J. B. Thompson and one of said notices
near the center of said proposed road on the north side of Catherine
Creek near the bridge across Catherine Creek, all of said places
being public places and a fourth notice was posted on the bulletin
board at the Court House at LaGrande, in Union County Oregon at
the place where the County Court holds court, said notices and copies
thereof were posted on the 29th day of April 1914, the same being
more than thirty days previous to the time when said petition is
presented to the County Court for action thereon; said petition
being presented to this County Court at their first regular meet-
ing after thirty days had elapsed from first posting of said notices ;
said petition notifying all persons concerned that application would
be made to said county court at their next session for laying out
such road.

Affiant further says, that the said proposed road is now
and has been for more than ten years last past a public highway
but makes this affidavit for purpose of proving posting notices and
for purpose of having same so declared by County Court.

to a County Road and to have the same of record.

J B Thomas

Subscribed and sworn to before me this 3rd day of June 1914

Redney J. Kitchen
Notary Public for Oregon.

TRURO COUNTY COURT

NOTARY PUBLIC

STATE OF OREGON

NOTARY PUBLIC

[Handwritten signatures and scribbles]

[Faint handwritten notes and signatures]

to County Head and to have the same of record.

Subscribed and sworn to before me this 2nd day of June 1914

Notary Public for Oregon.

659

IN THE
COUNTY COURT

FOR THE
STATE OF OREGON
FOR
UNION COUNTY

In the matter of the

Ed Paul Peterson
for by J. A. Simmons

FILED *July 1* 1914
David Clark
Clerk

By

Deputy

Simmons

SECOND JUDICIAL DAY.

THURSDAY, JUNE 4th, 1914.

In the matter of the proposed
County road petitioned for by
Dexter Eaton et al.

Now at this time it is ORDERED that this matter be, and the same is hereby continued
for the term.

In the matter of the proposed
County Road petitioned for by
H. H. Hug et al.

Now at this time it is ORDERED that this matter be, and the same is hereby continued
for the term.

In the matter of the proposed
County Road petitioned for by
Dunham Wright et al.

Now at this time it is ORDERED that this matter be, and the same is hereby continued
for the term.

In the matter of the proposed
County Road petitioned for by
J. B. Thomson et al.

Now at this time it is ORDERED that this matter be, and the same is hereby continued
for the term.

In the matter of the petition
of C. H. Law et al for road
crossing.

Now at this time it is ORDERED that this matter be, and the same is hereby continued
for the term.

In the matter of the approval
of Widow's Pensions.

Now at this time is presented to the court the orders of the Juvenile Court awarding
to Mrs. Nellie M. Martin the sum of \$40.00 per month, to Mrs. Minnie Shaw the sum of \$17.50
per month, and to Mrs. Frances Leonard the sum of \$17.50 per month, as widow's pensions
under the provisions of the Widow's Pension Law, and it appearing to the court that said
orders are in conformity with law,

It is therefore CONSIDERED and ORDERED that same be approved and the Clerk of this
Court is hereby directed to issue warrants accordingly until the further orders of the
Juvenile Court.

SECOND JUDICIAL DAY.

THURSDAY, JULY 2nd, 1914.

In the matter of the proposed county road petitioned for by J. B. Thomson et al.

WHEREAS, a petition has been filed in this court requesting that a county road be laid out along the following route, to-wit: Beginning at a point on the county road between Union and Medical Springs about 20 rods east of the west section corner common to Sections 16 and 21, where the wagon road heretofore used as such branches from said regular county road leading from Union to Medical Springs, township 5 south, range 41 E.W.M. in road district No. 8, thence along the line of the old road up Catherine Creek a distance of about one-half mile where such road crosses a bridge; thence continuing along said old road up Catherine Creek a distance of three quarters of a mile further to the section line between sections 21 and 22, township 5 south, range 41 East to what is known commonly as the Thompson Place or Summer Resort.

AND, WHEREAS, the laying out and establishment of the road as above described is considered of public necessity.

Therefore, BE IT RESOLVED, that the County Surveyor be and he is hereby ordered and directed to make an examination of the proposed route of said road as provided by law.

In the matter of the proposed county road petitioned for by J. M. Choate et al.

WHEREAS, a petition has been filed in this court requesting that a county road be laid out along the following route, to-wit: Commencing 50 rds. more or less, east of the N.W. cor. of the S.E. Quarter $\frac{1}{4}$ of the N.W. Quarter $\frac{1}{4}$ of Section 19, running E. 30 rds more or less to the N.E. corner of the S.E. quarter $\frac{1}{4}$ of the N.W. Quarter $\frac{1}{4}$ of Section 19, then south 80 rds, then SE 55 more or less to the intersection of the old road at a point near the N.W corner of the Elmer Orchard, all in Township 1 S. R. 39 E. Willamette Meridian.

AND, WHEREAS, the laying out and establishment of the road as above described is considered of public necessity.

Therefore, BE IT RESOLVED, that the County Surveyor be and he is hereby ordered and directed to make an examination of the proposed route of said road as provided by law.

In the matter of the application of the Klees Electric Co. for franchise to use certain county roads for electrical transmission line purposes.

Now at this time this matter came on before the court upon the application of the Klees Electric Co. for the right to cross certain county roads with electrical transmission lines and to use other roads for the right of way of said electrical transmission lines under the statutes in such cases made and provided.

SECOND JUDICIAL DAY.

THURSDAY, AUGUST 6th, 1914.

In the matter of the approval
of Widow's Pensions.

Now at this time is presented to the court the orders of the Juvenile Court awarding Widow's Pensions as follows: to Phebe Wilson the sum of \$4.00 per month, to Eliza E. McLaren the sum of \$32.50 per month and to Vida Hedgpeth the sum of \$25.00 per month as Widow's Pensions under the provisions of the Widow's Pension Law; and it appearing to the court that said orders are in conformity with law.

It is therefore CONSIDERED and ORDERED that same be approved and the Clerk of this Court is hereby directed to issue warrants accordingly until the further orders of the Juvenile Court.

In the matter of the proposed
county road petitioned for by
M. G. Church et al.

Now at this time it is ORDERED that this matter be, and the same is hereby continued for the term.

In the matter of the proposed
county road petitioned for by
J. M. Choate et al.

Now at this time it is ORDERED that this matter be, and the same is hereby continued for the term.

In the matter of the proposed
county road petitioned for by
J. B. Thomson et al.

Now at this time it is ORDERED that this matter be, and the same is hereby continued for the term.

In the matter of the proposed
county road petitioned for by
Dexter Eaton et al.

Now at this time it is ORDERED that this matter be, and the same is hereby continued for the term.

In the matter of the proposed
county road petitioned for by
H. H. Hug et al.

Now at this time it is ORDERED that this matter be, and the same is hereby continued for the term.

SECOND JUDICIAL DAY.

THURSDAY, SEPTEMBER 3rd, 1914.

Commencing at a point where the County road crosses the railroad logging grade of the Palmer Lumber Company at the Palmer Lumber Company Camp No. 1, thence following said railroad grade in an easterly direction to a point about one-fourth of a mile south of Palmer Junction Oregon, where said grade intersects with County road on the west side of the Grande Ronde River (grade intersecting with proposed county road being built from north end of Crickett Flatt; and vacating the present county road extending from Palmers Lumber Companys Camp No.1 to Palmer Junction, Oregon.

AND, WHEREAS, the paying out and establishment of the road as above described is considered of public necessity.

Therefore, BE IT RESOLVED, that the County Surveyor be and he is hereby ordered and directed to make an examination of the proposed route of said road as provided by law.

In the matter of the proposed County road petitioned for by M. G. Church et al.

WHEREAS, a petition has been filed in this court requesting that a county road be laid out along the following route, to-wit:

Beginning at a point 76 rods northeast of the southeast corner of the northeast quarter of the southwest quarter of Section 33, Township 5 South Range 40 E.W.M., and being 70 feet northwest of the center of the O.W.R. & N. Co's track, and connecting with the main road leading from Telocaset to Medical Springs; thence running southwesterly and along the north side of the said O. W. R. & N. Co's track to a point 72 rods east and 27 rods south of the northwest corner of the northeast quarter of Section 6 Township 6 South Range 40 E.W.M.; thence in a northwesterly direction to a point 21 rods east and 30 rods north of the southwest corner of the SE $\frac{1}{4}$ Sec. 31, Tp. 5 S. R. 40 E.W.M. and connecting with the Union County road running from North Powder to Telocaset at Government Gulch. Said road to be 40 ft. in width.

AND, WHEREAS, the paying out and establishment of the road as above described is considered of public necessity.

Therefore, BE IT RESOLVED, that the County Surveyor be and he is hereby ordered and directed to make an examination of the proposed route of said road as provided by law.

In the matter of the proposed County road petitioned for by J. B. Thomson et al.

Now at this time this matter came on for hearing upon the report of the County Surveyor, and it appearing to the court that the said County Surveyor has made a favorable report, and it appearing to the court from said report of the County Surveyor that said road will be of utility and convenience to individuals and the public.

It is therefore CONSIDERED and ORDERED that the County Surveyor be and he is hereby directed to make a survey and plat of said proposed road and report to this court before the first day of the next term.

In the matter of the proposed County road petitioned for by W. E. Thompson et al.

Now at this time this matter came on for hearing upon the report of the County Surveyor, and it appearing to the court that the said County Surveyor has made a favorable report, and it appearing to the court from said report of the County Surveyor that said

SECOND JUDICIAL DAY.

THURSDAY, NOVEMBER 5th, 1914.

In the matter of the proposed county road petitioned for by M. J. Church et al.

Now at this time it is ORDERED that this matter be, and the same is hereby continued for the term.

In the matter of the proposed county road petitioned for by A. G. Paddock et al.

Now at this time it is ORDERED that this matter be, and the same is hereby continued for the term.

In the matter of the proposed county road petitioned for by H. H. Hug et al.

Now at this time it is ORDERED that this matter be, and the same is hereby denied.

In the matter of the proposed county road petitioned for by Dexter Eaton et al.

Now at this time it is ORDERED that this matter be, and the same is hereby denied.

In the matter of the proposed change in county road petitioned for by W. T. Wright et al.

Now at this time it is ORDERED that this matter be, and the same is hereby denied.

In the matter of the proposed county road petitioned for by J. B. Thomson et al.

Now at this time this petition came on for final hearing upon the report of the County Surveyor, and it appearing to the court that said County Surveyor has filed in writing his report recommending that the prayer of the petitioners be granted, and that an actual survey of the same be made and plat thereof filed, and there being no remonstrance filed nor claim for damages.

It is therefore CONSIDERED and ORDERED that said petition be and the same is hereby granted and said road declared to be and established as a county road on the following line or route, to-wit:

Beginning at a point on the county road between Union and Medical Springs about 20 rods east of the west section corner common to sections 16 and 21, where the wagon road heretofore used as such, branches from said regular county road leading from Union to Medical Springs, township 5 South, Range 41 E.W.M. in road district No. 8, thence along the line of the old road up Catherine Creek a distance of about one-half mile where such road crosses a bridge; thence continuing along said old road up Catherine Creek a distance of three quarters of a mile further, to the section line between sections 21 and 22; township 5 south, range 41 East to what is known commonly as the Thompson Place or Summer Resort.

1656
1657
1658
1659