

BE IT REMEMBERED, That at a regular term of the County Court of the State of Oregon, for the County of Union, sitting for the transaction of County business, begun and held at the Court House in the City of La Grande, in said County and State, on Wednesday, the 4th day of June, A. D., 1913, the same being the first Wednesday of said month and the time fixed by law for holding a regular term of said Court, when were present:

- The Honorable J.C. Henry, County Judge,
- C.A. Galloway, Commissioner,
- J.F. Hutchinson, Commissioner,
- Ed Wright, Clerk,
- August Hug, Sheriff.

WHEN, on Thursday, the 5th day of June, A. D. 1913, or the 2nd Judicial Day of said term, among others the following proceedings were had, to-wit:

In the matter of the proposed County Road petitioned for by W. R. Peck et al.

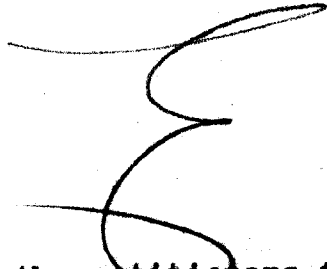

Comes now Wm. R. Peck, one of the petitioners for the above named proposed County Road, and presents to the Court the petition of himself and others, praying for the location and establishment of a county road, described as follows, to-wit:

Commencing at the southwest corner of the northeast quarter of the southwest quarter of Section 8, Township 2 North of Range 40 E.W.M., running thence due north a distance of one and one-half mile, thence in a northeasterly direction to the bottom of the Canyon, thence following the Canyon to a point on the Grande Ronde River at the mouth of the Canyon near where is located an O.W.R. & N. Co. mile post and being about one mile south of Palmer Junction, thence north about one-quarter of a mile following the East bank of said river, thence across said river, thence north on the west side of said river to the water tank of O.W.R. & N. Co a distance about 40 rods, thence following the railroad track on the west side thereof to the bridge at the mouth of Looking Glass creek, and there terminating, intersecting with the County road;

Also, commencing at the southeast corner of the northeast quarter of Section 32, Township 3 North of Range 40 E.W.M., thence in a northwesterly direction to a point about 30 rods north of the center of said Section 32, thence in a westerly direction to a point 30 rods north of the southwest corner of the northwest quarter of said Section 32, thence in a northwesterly direction to a point intersecting with the road above described where it crosses the Grande Ronde river on the east bank thereof, and there terminating.

And it appearing to the court that said petition is signed by more than twelve freeholders of this county, residing in the road district where the hereinbefore described road is proposed to be, and that said petition properly specifies the place of beginning, intermediate points and place of termination of said road, and it satisfactorily appearing to the court that notice has been given by advertisement posted at the place of holding County Court, to-wit: At the Court House in the City of La Grande, Union County, Oregon, and also in three public places in the vicinity of said proposed road, to-wit: one on a tree at the southwest corner of the northeast quarter of the southwest quarter of Section 8, Township 2 North of Range 40 E.W.M. and being at a point described as ~~the~~

the commencement of said proposed road; also one on a tree at the southeast corner of the northeast quarter of Section 32, Township 3 North of Range 40 E.W.M. and being at the other or commencement end of said proposed road, and one at a point where the proposed road described in the petition herein intersects with the county road at the mouth of Looking Glass creek, on the bridge crossing said creek, and being at the terminus of the said described road.

, for more than thirty days immediately prior to the presentation of said petition to this court, notifying all persons concerned that application would be made to this court, at the present session of this court, and that the notices so posted were in due form and duly signed by the petitioners, and that a bond for the cost of this proceeding has been duly given.

It is therefore ORDERED that C. T. Darley, County Surveyor, and Thos. Brasher and E. A. Wills, constituting the Board of County Road Viewers, be, and they are hereby directed to meet at Elgin, Oregon, on the 16th day of June, 1913, at the hour of 11 o'clock A.M., or within five days thereafter and proceed to survey, view and lay out said road according to law.

(Signed) J.C. Henry County Judge
C.A. Galleway, Commissioner,
J.F. Hutchinson, Commissioner

Attest:

County Clerk.

WTR Beck
Road

The following information was obtained from the records of the
County of San Diego, California, and is being furnished to you
for your information. It is not intended to constitute a
guarantee or warranty of any kind, and it is not to be used
for any purpose other than that for which it was prepared.
The information is based on the records of the County of San Diego,
California, and is not intended to constitute a guarantee or
warranty of any kind, and it is not to be used for any purpose
other than that for which it was prepared. The information is
based on the records of the County of San Diego, California,
and is not intended to constitute a guarantee or warranty of any
kind, and it is not to be used for any purpose other than that
for which it was prepared.

37-10-17-18

BE IT REMEMBERED, That at a regular term of the County Court of the State of Oregon, for the County of Union, sitting for the transaction of County business, begun and held at the Court House in the City of La Grande, in said County and State, on Wednesday, the 6th day of August, A. D., 1913, the same being the first Wednesday of said month and the time fixed by law for holding a regular term of said Court, when were present:

The Honorable J.C. Henry, County Judge,
C.A. Galloway, Commissioner,
J.F. Hutchinson, Commissioner,
Ed Wright, Clerk,
August Hug, Sheriff.

WHEN, on Wednesday, the 6th day of August, A. D. 1913, or the first Judicial Day of said term, among others the following proceedings were had, to-wit:

In the matter of the proposed county road petitions for by Wm. R. Peck et al.

Now at this time this matter came on to be heard upon the Report of the Board of County Road Viewers for a first reading as provided by law, and the said report having now been read in open court the said is laid over for a second reading upon another day of this term of court.

(Signed) J.C. Henry, County Judge
C.A. Galloway, Commissioner
J.F. Hutchinson, Commissioner

Be it Remembered, That at a regular term of the County Court of the State of Oregon, for the County of Union, begun and held at the Court House, in the City of Union, said County and State, on Wednesday, the 5th day of August A. D. 1903, the same being the first Wednesday in said month and the time fixed by law for holding a regular term of said Court, when were present to-wit:

The Hon. J. C. Henry Judge, Presiding.

The Hon. C. A. Galloway County Commissioner.

The Hon. J. F. Hutchinson County Commissioner.

Ed Wright Clerk.

August Hug Sheriff.

When on Thursday, the 7th day of August A. D. 1903, or the second Judicial day of said term, among others, the following proceedings were had, to-wit:

In the Matter of the Proposed County Road Petitioned
for by Wm. R. Peck et al.

This matter came to be heard at this time on the report of the Board of County Road Viewers for a second reading, as provided by law, said report being in words following to-wit:

REPORT OF BOARD OF COUNTY ROAD VIEWERS.

To the Honorable County Court of Union County, Oregon:

The undersigned Board of County Road Viewers heretofore on the fourth day of June 1903, instructed to view, lay out and alter the proposed county road, of which the survey hereto attached is a true and correct description, as petitioned for by Wm. Peck et al., beg leave to report that on the 18 day of June, 1913, in pursuance with said order, we proceeded to view out said proposed road for the whole distance thereof, and that in our opinions said proposed road should be laid out and established as a public highway of Union County, Oregon; that the same is practicable and would add greatly to the convenience of the householders residing in the vicinity thereof. We therefore recommend that said proposed road be laid out and declared a public highway of said county Provided the petitioners and residents construct the road. We would recommend the county to construct the bridge and approaches at the crossing of the Grande Ronde River.

(Sd) D. L. Johnson

C. T. Darley

} Board of County
Road Viewers.

And said report of the Board of County Road Viewers having been now publicly read in open court on two several days of the present term of the court, and it appearing to the court that said Board of County Road Viewers report favorably thereon, and recommend that said proposed road be established as a county road and be declared a public highway of Union County, Oregon, and all the

proceedings herein having been regular and according to law, and no remonstrance or claim for damages having been filed herein

and there having been no cause shown why this proposed road should not be declared a public highway and ordered open according to law, and the court being satisfied from the report of the Board of County Road Viewers that such road will be of public utility; the report of the viewers being favorable thereto, and all the files and records of said proceedings having been submitted to the District Attorney, who has advised this court as to the legality of said proceedings, it is therefore considered and ordered by the court that the report of the Board of County Road Viewers be placed on record in this journal, and that the surveyor's profile and plat of the proposed road, and his field-notes of the survey thereof be placed on record in the Book of Plats of County Roads of Union County, Oregon, and that said proposed road be declared a public highway of Union County, Oregon, and ordered opened up and placed in repair for travel according to law, and that ~~the payment into court by the petitioners of the expense of opening the road and the damages~~

_____ Road Supervisor of Road District No. 4 _____, the same being the road district in which said road is located, be furnished with a copy of the petition herein, and a copy of this decree and ordered to open up said road and place the same in repair for travel, upon the payment into court of the expenses of opening the road and damages.

(Signed) J.C. Henry
County Judge.

C.A. Galloway
Commissioner.

J.F. Hutchinson
Commissioner.

STATE OF OREGON, }
COUNTY OF UNION, } ss.

I, _____, Clerk of the County Court of the State of Oregon for the County of Union, do hereby certify that the foregoing copy of Journal Entry has been by me compared with the original entry made in the above entitled proceedings, now remaining of record in my office; that it is a correct transcript therefrom, and the whole of such original.

IN WITNESS WHEREOF, I have hereunto set my hand and the seal of the said court this _____ day of _____ A. D. 190_____

Clerk.

By _____
Deputy.

The following are the alignment notes of the Co. Road as petitioned for by Mrs Beck et al.

Beginning at the SE Cor of NW 4 of NW 4 sec. 8. T. 31 N

Range 40 E. Wm. thence north ~~1960~~ 7240 feet. to Δ a stake;

Thence N 15° E 506 ft. to angle 1 st stake;	Thence N 30° E 204'	" Δ " "	1
" N 28° 15' W 258 " "	" N 20° 40' E 330'	" angle 5 ^a "	3
" N 10° 45' W 260 " "	" N 5° W 156 "	" " 7 " "	3
" N 18° E 86 " "	" N 8° 30' E 414 "	" " 9 " "	3
" N 36° 45' W 53' " "	" N 49° W 118 "	" " 11 " "	3
" N 28° W 187 " "	" N 36° W 400 "	" " 13 " "	3
" N 18° W 142 " "	" N 13° 40' E 136 "	" " 15 " "	3
" N 34° W 370 " "	" N 63° W 83 "	" " 17 " "	3
" N 50° W 125 " "	" S 88° W 116 "	" " 19 " "	3
" N 53° W 360 " "	" N 11° W 208 "	" " 21 " "	3
" N 46° W 310 " "	" N 33° W 220 "	" " 23 " "	3
" N 38° 30' W 141 " "	" N 74° W 340 "	" " 25 " "	3
" N 24° W 320 " "	" N 77° W 465 "	" " 27 " "	3
" N 57° W 840 " "	" N 35° W 279 "	" " 29 " "	3
" N 10° W 154' " "	" N 4° E 265' "	" " 31 " "	3
" N 47° E 205' "	" N 84° E 990 "	" " 33 " "	3
" S 81° E 160 " "	" S 71° E 94 "	" " 35 " "	3
" S 82° E 119 " "	S 70° E 144 "	" " 37 " "	3
" N 40° E " "	" N 89° 30' E 875' "	" " 38 " "	3
" N 58° 15' E 510' " "	" N 78° 15' E 494' "	" " 40 " "	3
" N 86° 15' E 230 " "	" N 31° 30' E 475' "	" " 42 " "	3
" N 58° 45' E 265' " "	" N 08° E 520' "	" " 44 " "	3
" N 12° 30' E 212' " "	" N 28° 30' W 270' "	" " 45 " "	3
" N 5° E 315' " "			

Carlton Branch.

Beginning at the 1/4 corner common to Sections 32 and 33

Thence N 82° 30' W 740' to angle 2 nd stake;	Thence north 589 ft. to angle 1 st stake;
" N 80° W 495' " " 4 " " "	" N 85° W 215' " " 3 " " "
" N 80° W 495' " " 4 " " "	" N 87° 30' 400' " " 5 " " "

(over) (See Back of sheet.)

Thence S 62°W ¹⁴⁴⁵ ~~726~~ ft. angle 6 a stake; Thence S 77°15'W 575' to angle 7 ending
 Thence N 66°15'W 710 " " " 8 " " " " S 29°30' E 688 " " 9 " "
 " " 63°46'W 574 " " " 10 " " " " N 53°30' W 718 " " 11 " "
 " " 56°W 422 " " " 12 " " " " N 53°45' E 609 " " 13 " "
 " " 77°30'W 1014 " " " 14 " " " " N 44°30' E 170 " " 15 " "
 " " 49°15' E 260 " " " 16 " " " " " 73° E 88 " " 17 " "

Road Terminus Δ17 = Beck Branch. Δ35.

Approximate Cost of Beck Road.

Beck Branch. Beginning to River.

5-30 ft. Bridge @ ~~\$50.00~~ ^{\$50.00} ----- 250.00
 Road construction ----- 450.00
 Total ----- \$700.00

Carlton Branch

Road Construction ----- 175.00

^{\$500.00 and \$1250.00}
 Bridge ^{at} approaches (Steel) complete with ^{concrete piers} ----- \$6200.00

Road Construction from Bridge to terminus.

1 Bridge ----- \$80.00
 Road construction ----- 150.00
 Steel span 100 ft. ----- \$230.00

Total ----- \$7305.00

Using 2-span wood structure

Bridge complete with fiers ----- \$2200.00
 " Approach ----- 600.00
 Each span ----- \$3800.00
\$2800.00

C. T. Darley Co. Surveyor.

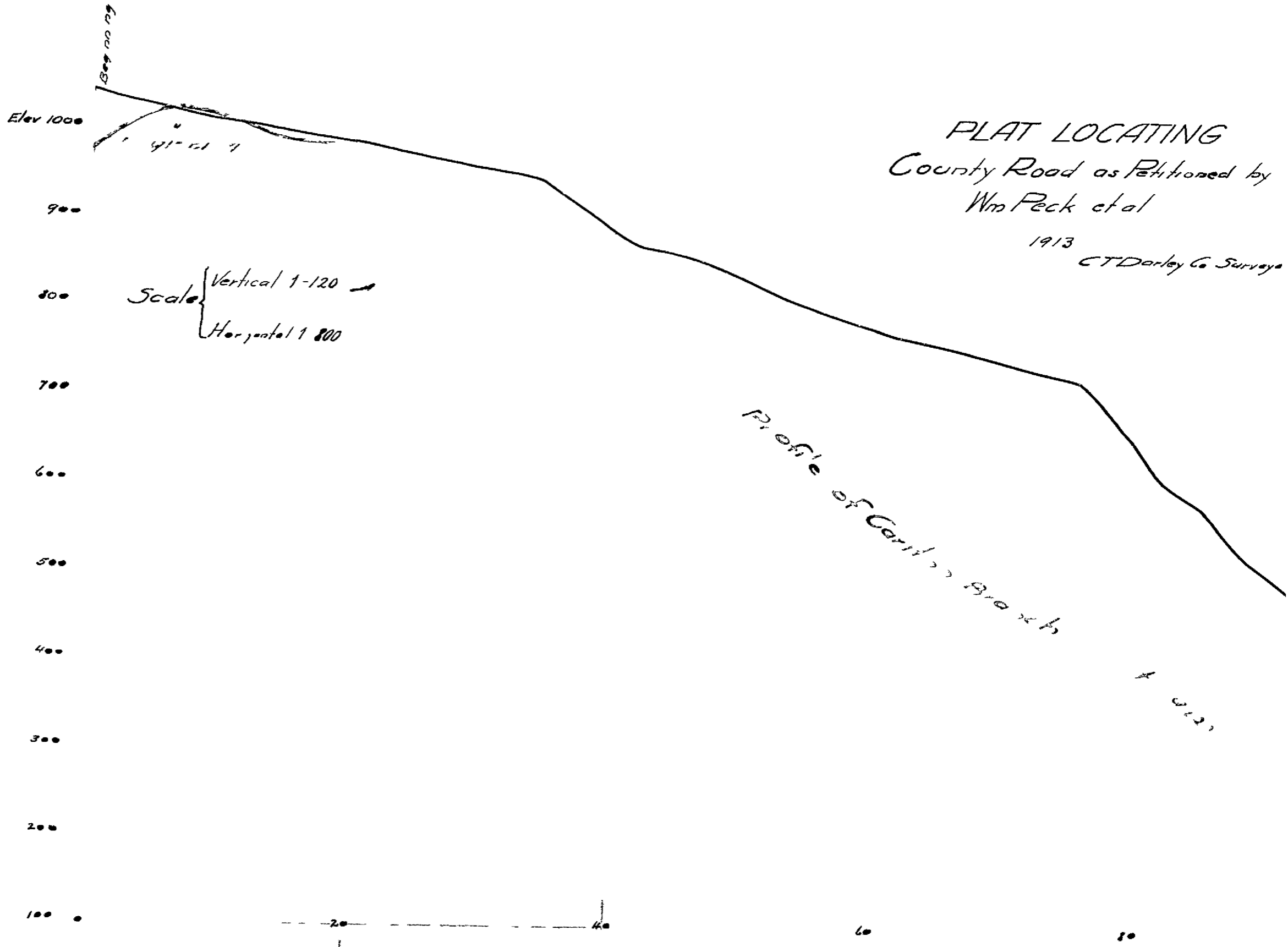

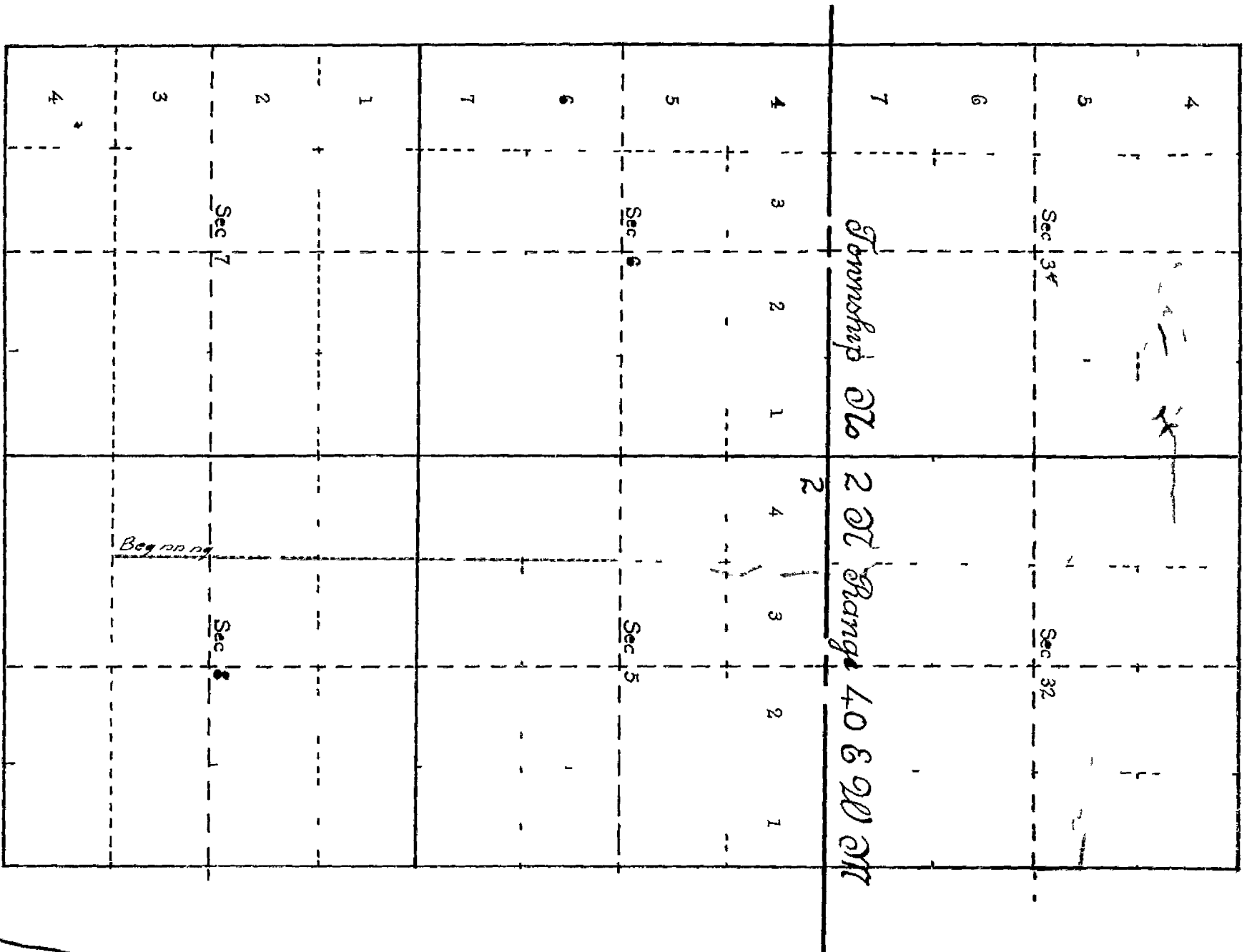

Sketch of Road Location
Scale 1/1760

Turn us

Dr-2

100

120

140

160

180

148
196
x

REPORT OF BOARD OF COUNTY ROAD VIEWERS.

To the Honorable County Court for Union County, Oregon:

The undersigned Board of County Road Viewers, heretofore on the Fourth day of June 1903, instructed to view, lay out and alter the proposed county road, of which the survey hereto attached is a true and correct description, as petitioned for by My Beck et al

et al, beg leave to report that on the 18 day of June 1903, in pursuance with said order, we proceeded to view out said proposed road for the whole distance thereof, and that in our opinions said proposed road should ~~be~~ laid out and established as a public highway of Union county, Oregon; that the same ~~is~~ is practicable and would add greatly to the convenience of the householders residing in the vicinity thereof.

We therefore recommend that said proposed road be laid out and declared a public highway of said county. Provided the petitioners and residence construct the road, He would recommend the county to construct the Bridge and approaches at the crossing of the Grande Ronde River.

D. Johnson
C. T. Darley

Board of County Road Viewers.

648

Rock Road

Robert G. Burns

West Aug 6-1913
Sawley
Allen



Received
7-9-53
ZRC.

We, the undersigned, residents of Elgin District, Union County, State of Oregon, in consideration of the benefits accruing therefrom, hereby subscribe and agree to pay the amount set opposite our names to secure the right of way and Public road described on Exhibit "A" attached hereto and made a part hereof, according as the same shall be granted by the County Court of Union County, Oregon and laid out.

1
2
3
4
5
6
7
8
9
10
11
12
13
14
15
16
17
18
19
20
21
22
23
24
25
26
27
28
29
30
31
32

Wm B. Peak	25.00
Blw Whiting	25.00
U. F. Weiss	25.00
J. P. Good	25.00
Earl Phillips	25.00
W. Carlton	25.00
Thomas Scott	25.00
Mr. Fine	25.00

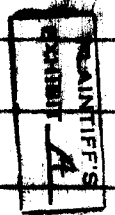

1
Exhibit A

PETITION FOR COUNTY ROAD.



TO THE HONORABLE COUNTY COURT, FOR UNION COUNTY, OREGON:

The undersigned freeholders, of Union county, Oregon, residing in the road district where the hereinafter described road is proposed to be, respectfully petition your Honorable body to lay out, alter and establish a County Road within said county, on the following line, or route, to-wit:

Commencing at the Southwest corner of the Northeast quarter of the Southwest quarter of Section 8, Township 2 North of Range 40 E.W.M., running thence due North a distance of one and one-half mile, thence in a Northeast rly direction to the bottom of the Canyon, thence following the Canyon to a point on the Grande Ronde river at the mouth of the Canyon near where is located an O.W.R. & N. Co. mill Post and being about one mile South of Palmer Junction, thence North about one-quarter of a mile following the East bank of said river, thence across said river thence North on the West side of said river to the Water tank of O.W. R. & No. Co. a distance about 40 rods, thence following the railroad track on the West side thereof to the bridge at the mouth of Looking Glass creek, and there terminating, intersecting with the County road;

Also, Commencing at the Southeast corner of the Northeast quarter of Section 32, Township 3 North of Range 40 E.W.M., thence in a North-westerly direction to a point about 30 rods North of the centre of said

Section 32, thence in an Westerly direction to a point 30 rods North of the Southwest corner of the Northeast quarter of said Section 32, thence in a North-westerly direction to a point intersecting with the road above described where it crosses the Grande Ronde river on the East bank thereof, and there terminating.

20
And in 21
22
23

NAMES:

NAMES:

Large area with horizontal dashed lines for signature entries.

79#

THE LEGAL PUBLISHING COMPANY, BOSTON, MASS.

--	--	--	--

FROM THE LAW OFFICE OF
L. DENHAM
ELGIN, OREGON

PETITION FOR COUNTY ROAD.



TO THE HONORABLE COUNTY COURT, FOR UNION COUNTY, OREGON:

The undersigned freeholders, of Union county, Oregon, residing in the road district where the hereinafter described road is proposed to be, respectfully petition your Honorable body to lay out, alter and establish a County Road within said county, on the following line, or route, to-wit:

Commencing at the Southwest corner of the Northeast quarter of the Southwest quarter of Section 8, Township 2 North of Range 40 E.W.M., running thence due North a distance of one and one-half mile, thence in a North-easterly direction to the bottom of the Canyon, thence following the Canyon to a point on the Grande Ronde river at the mouth of the Canyon near where is located an O.W.R. & N. Co. mile Post and being about one mile South of Palmer Junction, thence North about one-quarter of a mile following the East bank of said river, thence across said river thence North on the West side of said river to the Water tank of O.W. R. & N. Co. a distance about 40 rods, thence following the railroad track on the West side thereof to the bridge at the mouth of Eeking Glass creek, and there terminating, intersecting with the County road;

Also, Commencing at the Southeast corner of the Northeast quarter of Section 32, Township 3 North of Range 40 E.W.M., thence in a North-westerly direction to a point about 30 rods North of the centre of said

Section 32, thence in an Westerly direction to a point 30 rods North of the Southwest corner of the Northeast quarter of said Section 32, thence in a North-westerly direction to a point intersecting with the road above described where it crosses the Grande Ronde river on the East bank thereof, and there terminating.

20
21
22
23

NAMES:

NAMES:

Wm R Beck
J. A. Barnes
W. W. Whiting
W. F. Weier
W. A. Clemmons
J. P. Good
Jonathan Green
A. E. Ryedam
A. Wood
W. H. Ryedam
Carl Phillips
A. Carlton
J. P. Forehears
Wm S. Peters
W. H. Cruikshank, Jr.
Albert Ryedam
J. C. Ryedam
O. R. Carver
Overton Scott
J. Beckel

Albert Scott
E. W. English
F. O. Harryman
W. Carlton
Wm Miller
M. Fitzgerald
Thomas Scott
H. Stowe
L. V. Witty
J. C. Witherspoon
B. F. Cruikshank
S. S. Thompson
J. T. Wickens
Grande Ronde Lbr Co
By E. W. Stoddard.
The George Palmer Lumber Co.
By George Palmer
Wm Fine.

Notice of Road Petition.

To all Persons Concerned: You, and each and all of you, will take notice that the under-
 signed, free holders for Union County, Oregon, residing in the Road District
 or Road Districts where the hereinafter described road is proposed to be, will at the next session of the
 County Court for Union County, Oregon, to-wit: on Wednesday the
4th. day of June A.D. 1913 ~~XXXXXX~~, respectfully present to said Court
 a petition praying said Court to lay out, alter and establish a County Road within said County, on the
 following line of route, to-wit: beginning at

Commencing at the Southwest corner of the Northeast quarter of the
 Northwest quarter of Section 3, Township 2 North of Range 40 E.W.M., run-
 ning thence east North a distance of one and one-half mile, thence in a
 North-easterly direction to the bottom of the Canyon, thence following
 the Canyon to a point on the Grande Ronde river at the mouth of the
 Canyon near where is located an O.W.R. & N. Co. mile Post and being
 about one mile South of Palmer Junction, thence North about one-quarter
 of a mile following the East bank of said river, thence across said river,
 thence North on the West side of said river to the Water tank of O.W.
 R. & N. Co. a distance about 40 rods, thence following the railroad
 track on the West side thereof to the bridge at the mouth of Looking
 Glass creek, and there terminating, intersecting with the County road;

Also, Commencing at the Southeast corner of the Northeast quarter
 of Section 32, Township 3 North of Range 40 E.W.M., thence in a North-
 westerly direction to a point about 30 rods North of the centre of said

Section 32, thence in an Westerly direction to a point 30 rods
 North of the Southwest corner of the Northwest quarter of said
 Section 32, thence in a Northwesterly direction to a point inter-
 secting with the road above described where it crosses the Grande
 Ronde river on the East bank thereof, and there terminating.

NAMES

NAMES

Wm R Peck
 D A Jones
 J W Whiting
 U. F. Weiss
 Mrs. & Clemmons
 J. P. Good
 Southern Green
 J. B. Pysdam
 Wm H. Pysdam
 Earl Phillips
 J. C. Carlton
 J. B. Bresheare
 Mrs. A. Peters
 W. H. Crankshaw Jr.
 Albert Pysdam
 J. E. Pysdam
 J. R. Barber
 Overton Scott
 Jos Bechtel

Albert Scott
 P. W. English
 B. O. Harryman
 W. Carlton
 Wm Miller
 Wm Fitzgerald
 J. H. Scott
 H. Stowe
 J. V. Witten
 J. W. Witherspoon
 B. J. Lynch
 S. S. Thompson
 J. T. Wheeler
 Grande Ronde Stake
 By H. W. Stoddard
 M. G. G. G. G. G. G.
 J. G. G. G. G. G.
 Wm Fine

STATE OF OREGON, }
 County of Union: } ss.

I, August Hug being first duly sworn, say that I posted ^{one}~~three~~ several notices, of which the notice hereunto attached is a true and correct copy, in ^{one}~~three~~ public places in said county in the vicinity of the proposed road therein described, to-wit: One

.....

Thirty days previous to the presentation of the road petition therein mentioned to-wit: On the day of ~~190~~....., and that thereafter and thirty days previous to the presentation of said road petition therein mentioned, to-wit: On the 3rd. day of May 1913, I posted a true and correct copy of said notice at the place of holding Court for Union County, Oregon, to-wit: On the front of the Court House door, in the City of La Grande, in the said County and State, and that said notices remained posted thirty days previous to the presentation of said petition as I verily believe.

August Hug, Sheriff

Subscribed and sworn to before me this 4th. day of June 1913.

L. Denham
 Notary Public for Oregon.

STATE OF OREGON, }
County of Union: } ss.

I, Earl Phillips being first duly sworn, say that I posted ~~three~~^{two} several notices, of which the notice hereunto attached is a true and correct copy, in ~~three~~^{two} public places in said county in the vicinity of the proposed road therein described, to wit: One ..on a tree at the Southwest corner of the Northeast quarter of the Southwest quarter of Section 8, Township 2 North of Range 40 E.W.M. and being at a point described as the commencement of said proposed road; Also, one on a tree at the Southeast corner of the Northeast quarter of Section 32, Township 3 North of Range 40 E.W.M., and being at the other or commencement end of said proposed road

Thirty days previous to the presentation of the road petition therein mentioned to-wit: On the 3rd. day of May 1913, and that thereafter and thirty days previous to the presentation of said road petition therein mentioned, to-wit: On the day of 190.., I posted a true and correct copy of said notice at the place of holding Court for Union County, Oregon, to-wit: On the front of the Court House door, in the City of La Grande, in the said County and State, and that said notices remained posted thirty days previous to the presentation of said petition as I verily believe.

Earl Phillips

Subscribed and sworn to before me this 3rd. day of June 1913.

L. Denham
Notary Public for Oregon.

STATE OF OREGON, }
County of Union: } ss.

I, W.R. Peck being first duly sworn, say that I posted ^{one} ~~three~~ several notices, of which the notice hereunto attached is a true and correct copy, in ~~five~~ ^{one} public places in said county in the vicinity of the proposed road therein described, to-wit: One at a point where the proposed road described in the petition herein intersects with the County road at the mouth of Looking Glass creek, on the bridge crossing said creek, and being at the terminus of the said described road.

Thirty days previous to the presentation of the road petition therein mentioned to-wit: On the 3rd. day of May 1913., and that thereafter and thirty days previous to the presentation of said road petition therein mentioned, to-wit: On the day of 190. ., I posted a true and correct copy of said notice at the place of holding Court for Union County, Oregon, to-wit: On the front of the Court House door, in the City of La Grande, in the said County and State, and that said notices remained posted thirty days previous to the presentation of said petition as I verily believe.

W. R. Peck

Subscribed and sworn to before me this 3rd. day of June 1913.

L. Denham
Notary Public for Oregon.

..Notice of Road Petition..

TO ALL PERSONS CONCERNED: You and each and all of you, will take notice that the undersigned freeholders, of Union County, Oregon, residing in the road district where the hereinafter described road is proposed to be, will at the next session of the County Court for Union county, Oregon, to-wit: on Wednesday, the 4th day of June A. D., 1933, respectfully present to said court a petition praying said court to lay out, alter and establish a County Road within said county, on the following line, or route, to-wit:

Dated at Elgin, Oregon, the 3rd day of May A. D., 1933.

NAMES:
 W^m R. Peck
 J. A. Barnes
 F. W. Whiting
 W. F. Weiss
 W. A. Clemmons
 J. P. Good
 Jonathan Green
 R. Rydau
 A. Wood
 W. H. Rydau
 Carl Phillips
 O. Carlton
 J. B. Brecheart
 W^m S. Peters
 W. H. Gritzkauk, Jr.
 Albert Rydau
 J. O. Rydau
 C. R. Carver
 Overton Scott

NAMES:
 J. P. Bechtel
 Gilbert Scott
 W. English
 F. O. Harriman
 N. Carlton
 W^m Miller
 M. Fitzgerald
 Thomas Scott
 H. Stowe
 L. V. Witty
 J. B. Witherspoon
 J. B. F. Gritzkauk
 J. S. Thompson
 G. T. Wickens
 Claude Rinde Dr. Co.
 By Geo. Stoddard.
 The George Palmer Lumber Co.
 By George Palmer
 W^m Fine.

Commencing at the Southwest corner of the Northwest quarter of the Southwest quarter of Section 8, Township 2 North of Range 40 E W M running thence due North a distance of one and one-half mile, thence in a Northeasterly direction to the bottom of the Canyon, thence following the Canyon to a point on the Grande Ronde river at the mouth of the Canyon near where is located an O W R & N Co mile Post and being about one mile South of Palmer Junction, thence North about one-quarter of a mile following the East bank of said river, thence across said river, thence North on the West side of said river to the Water tank of O W R & N Co a distance about 40 rods, thence following the railroad track on the West side thereof to the bridge at the mouth of Looking Glass creek, and there terminating, intersecting with the County road,

Also, Commencing at the Southeast corner of the Northeast quarter of Section 32, Township 3 North of Range 40 E W.M, thence in a North-westerly direction to a point about 30 rods North of the centre of said Section 32, thence in an Westerly direction to a point 30 rods North of the Southwest corner of the Northwest quarter of said Section 32, thence in a North-westerly direction to a point intersecting with the road above described where it crosses the Grande Ronde river on the East bank thereof, and there terminating

BOND OF ROAD PETITIONERS.



KNOW ALL MEN BY THESE PRESENTS, That we, Earl Phillips, W.R. Peck
and Willis Carlton & Wm. Fine, of the County of Union and State of Oregon, are
held and firmly bound unto said county of Union, in the full sum of ONE HUNDRED DOLLARS
(\$100.00) the payment of which, well and truly to be made, we bind ourselves, our heirs, exec-
utors and administrators firmly by these presents.

Signed this 24th day of May, A. D., 1913.

Now, the conditions of the above obligation is such, that whereas W.R. Peck
and others, have petitioned the County Court of said
county of Union, at the June term, 1913, thereof, for a County Road, de-
scribed in the petition and notice hereto annexed, as follows:

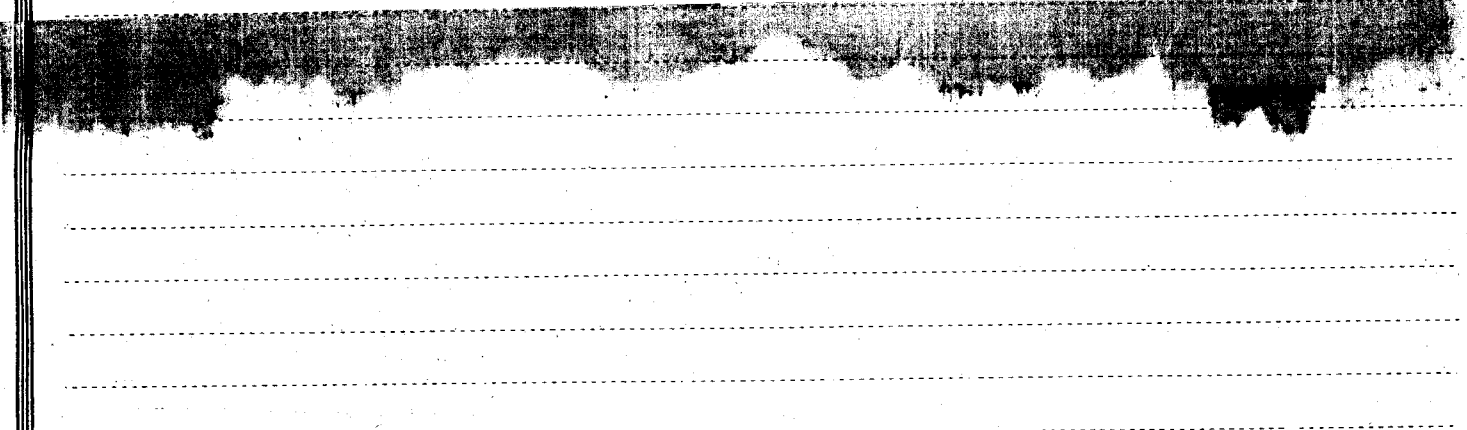

Now, if the above named Earl Phillips and W.R. Peck and Willis
Carlton and Wm. Fine
shall well and truly pay, or cause to be paid, all costs and expenses that may be incurred by
reason of the view or review of said road, in case the prayer of the petitioners be not granted or
allowed, then that this obligation shall be void, otherwise to remain in full force and virtue.

Earl Phillips (Seal.)
W.R. Peck (Seal.)
Willis Carlton
Wm. Fine

STATE OF OREGON, } ss.

COUNTY OF UNION,
Earl Phillips
W.R. Peck

Willis Carlton
Wm. Fine, each for himself, say

I am worth the sum of TWO HUNDRED DOLLARS (\$200.00) over and above all debts and
liabilities and property exempt from execution; that I am a resident householder in said county
and state,

Earl Phillips
W.R. Peck
Willis Carlton
Wm. Fine

Subscribed and sworn to before me this 24th day of

May A.D., 1913.

L. Denham
Notary Public for Oregon

648

[Handwritten initials]

COUNTY COURT

IN THE
FOR THE
STATE OF OREGON
FOR
UNION COUNTY

In the matter of the

[Handwritten signature]

[Handwritten signature]

[Handwritten signature]

[Handwritten signature]

FILED *[Handwritten signature]* 11 19 13

[Handwritten signature]
Clerk

[Small handwritten text]

Elementals & Ink's "A"

Revised 7-9-53 WRE

Commencing at the Southwest corner of the Northwest quarter of the southwest quarter of Section 8, Township 2 North of Range 40 E W M. running thence due North a distance of one and one-half mile, thence in a Northwesterly direction to the bottom of the Canyon, thence following the Canyon to a point on the Grande Ronde river at the mouth of the Canyon near where is located an O. W. R. & N. Co mile Post and being about one mile South of Palmer Junction, thence North about one-quarter of a mile following the East bank of said river, thence across said river thence North on the West side of said river to the Water tank of O. W. R. & N. Co a distance about 40 rods, thence following the railroad track on the West side thereof to the bridge at the mouth of Looking Glass creek, and there terminating, intersecting with the County road,

Also, Commencing at the Southeast corner of the Northeast quarter of Section 32, Township 3 North of Range 40 E W M., thence in a Northwesterly direction to a point about 30 rods North of the centre of said Section 32, thence in an Westerly direction to a point 30 rods North of the Southwest corner of the Northwest quarter of said Section 32, thence in a Northwesterly direction to a point intersecting with the road above described where it crosses the Grande Ronde river on the East bank thereof, and there terminating.

SECOND JUDICIAL DAY.

THURSDAY, JUNE 5th, 1913.

Court met pursuant to adjournment.

Present: Same officers as on last Judicial Day.

Due proclamation of the opening of Court having been made, the Journal of the last day's proceedings was read, approved and is here now signed.

J. B. Deery County Judge.
G. A. Gallaway Commissioner.
J. F. Hutchinson Commissioner.

Thereupon the following proceedings were had, to-wit:

In the matter of the monthly statement of the County Clerk of Scalp Bounty warrants issued.

Comes now Ed Wright, County Clerk, and presents to the court his statement of Scalp Bounty warrants issued, together with affidavits and receipts for warrants and scalps of animals on which warrants were allowed, the statement being as follows:

Name of Claimant.	No. of Warrant.	Amt. of Warrant
I. N. Warnstaff	583	\$ 3.00
J. M. Darr	584	12.50
R. D. Hamilton	585	1.50
Homer Littleton	586	6.00
R. W. Clerk	587	10.50
	Total	\$33.50

Said statement being in all things regular and according to law, it is ORDERED that the same be and is here now approved.

In the matter of the proposed County road petitioned for by W. R. Peck et al.

Comes now Wm. R. Peck, one of the petitioners for the above named proposed county road, and presents to the court the petition of himself and others, praying for the location and establishment of a county road, described as follows, to-wit:

Commencing at the southwest corner of the northeast quarter of the southwest quarter of Section 8, Township 2 North of Range 40 E.W.M., running thence due north a distance of one and one-half mile, thence in a northeasterly direction to the bottom of the Canyon, thence following the Canyon to a point on the Grande Ronde River at the mouth of the Canyon near where is located an O.W.R. & N. Co. mile post and being about one mile south of Palmer Junction, thence north about one-quarter of a mile following the east bank of said river, thence across said river, thence north on the west side of said river to the water tank of O.W.R. & N. Co. a distance about 40 rods, thence following the railroad track on the west side thereof to the bridge at the mouth of Looking Glass creek, and there terminating, intersecting with the county road;

Also, commencing at the southeast corner of the northeast quarter of Section 32, Township 3 North of Range 40 E.W.M., thence in a northwesterly direction to a point about 30 rods north of the center of said Section 32, thence in a westerly direction to a point 30 rods north of the southwest corner of the northwest quarter of said Section 32, thence in a northwesterly direction to a point intersecting with the road above described where it crosses the Grande Ronde river on the east bank thereof, and there terminating.

And it appearing to the court that said petition is signed by more than twelve freeholders of this county, residing in the road district where the hereinbefore described road is proposed to be, and that said petition properly specifies the place of beginning, intermediate points and place of termination of said road, and it satisfactorily appearing to the court that notice has been given by advertisement posted at the place of holding County

SECOND JUDICIAL DAY.

THURSDAY, JULY 3rd, 1913.

of said county. The residents propose that they furnish labor under county supervision for half the road.

(Signed) R. O. Wheeler) Board of County
 E. A. Wills)
 C. T. Darley) Road Viewers.

And said report of the Board of County Road Viewers having been now publicly read in open court on two several days of the present term of the court, and it appearing to the court that said Board of County Road Viewers report favorably thereon, and recommend that said proposed road be established as a county road and be declared a public highway of Union County, Oregon, and all the proceedings herein having been regular and according to law, and no remonstrance or claim for damages having been filed herein, and there having been no cause shown why this proposed road should not be declared a public highway and ordered open according to law, and the court being satisfied from the report of the Board of County Road Viewers that such road will be of public utility; the report of the viewers being favorable thereto, and all the files and records of said proceedings having been submitted to the District Attorney, who has advised this court as to the legality of said proceedings, it is therefore CONSIDERED and ORDERED by the court that the report of the Board of County Road Viewers be placed on record in this journal, and that the surveyor's profile and plat of the proposed road, and his field-notes of the survey thereof be placed on record in the Book of Plats of County Roads of Union County, Oregon, and that said proposed road be declared a public highway of Union County, Oregon, and ordered opened up and placed in repair for travel according to law, upon the payment into court of one half of the expense of opening said road, and that J.F.Campbell, Road Supervisor of Road District No. 3, the same being the road district in which said road is located, be furnished with a copy of the petition herein, and a copy of this decree and ordered to open up said road and place the same in repair for travel, upon payment into court by the petitioners of one half of the expense of opening the road.

In the matter of the proposed county road petitioned for by Wm. R. Peck et al.

Now at this time it is ORDERED that this matter be, and the same is hereby continued for the term.

In the matter of the application of Miller Brothers for cancellation of taxes.

Now at this time it is ORDERED that this matter be, and the same is hereby continued for the term.

FIRST JUDICIAL DAY.

WEDNESDAY, AUGUST 6th, 1913.

In the matter of the proposed county road petitioned for by Wm. R. Peck et al.

Now at this time this matter came on to be heard upon the Report of the Board of County Road Viewers for a first reading as provided by law, and the said report having now been read in open court the same is laid over for a second reading upon another day of this term of court.

In the matter of the Incorporation of the "City of Imbler."

Now at this time this cause came on upon the petition heretofore filed herein, and it appearing to the court that said petition was duly signed by 45 qualified voters of the County of Union, State of Oregon, residents within the limits of the proposed corporation, which petition prays that a portion of Union County, Oregon, therein particularly described, containing more than One Hundred and fifty inhabitants, and not already incorporated as a municipal corporation, might be incorporated under the provisions of Chapter 345, General Laws of Oregon, for 1913, under the incorporated name of the "City of Imbler"; and it further appearing that said petition was duly verified by Geo. L. Cleaver, Frank Barrett and Louis H. Bergold, residents of said proposed corporation. It further appearing to the court that the boundaries of said proposed municipal corporation, as specified in said verified petition, are proper and reasonable; that the number of inhabitants residing within such boundaries is more than one hundred and fifty; it is therefore

ORDERED and ADJUDGED that said petition be and the same is here now in all things granted and allowed. It is further ORDERED that an election be held on the 27 day of September, 1913, in such proposed corporation for the purpose of determining whether or not the same shall be incorporated as a municipal corporation to be known as "The City of Imbler" that notice of such election shall be given in the form and manner specified in Chapter 345 General Laws of Oregon for 1913.

Thereupon it was ORDERED that Court be now adjourned until tomorrow, August 7th, 1913, at 9 o'clock A.M.

SECOND JUDICIAL DAY.

THURSDAY, AUGUST 7th, 1913.

examined and found to be as required by law and having been heretofore approved as required by law by the county surveyor and the county assessor, and the Court being fully advised in the premises.

It is now CONSIDERED and ORDERED that the said correction dedication and plat of McDaniel's Third Addition to the town of Cove, Union County, Oregon, be and the same hereby is in all things approved and ordered filed, in accordance with law.

1648
In the matter of the proposed county road petitioned for by Wm. R. Peck et al.

This matter came to be heard at this time on the report of the Board of County Road Viewers for a second reading, as provided by law, said report being in words following to-wit

REPORT OF BOARD OF COUNTY ROAD VIEWERS.

TO THE HONORABLE COUNTY COURT OF UNION COUNTY, OREGON:

The undersigned Board of County Road Viewers heretofore on the fourth day of June, 1913, instructed to view, lay out and alter the proposed county road, of which the survey hereto attached is a true and correct description, as petitioned for by Wm. Peck et al., beg leave to report that on the 18 day of June, 1913, in pursuance with said order, we proceeded to view out said proposed road for the whole distance thereof, and that in our opinions said proposed road should be laid out and established as a public highway of Union County, Oregon; that the same is practicable and would add greatly to the convenience of the householders residing in the vicinity thereof. We therefore recommend that said proposed road be laid out and declared a public highway of said county. Provided the petitioners and residents construct the road. We would recommend the county to construct the bridge and approaches at the crossing of the Grande Ronde River.

(sd)-D L. Johnson) Board of County
C. T. Darley) Road Viewers.

And said report of the Board of County Road Viewers having been now publicly read in open court on two several days of the present term of the court; and it appearing to the court that said Board of County Road Viewers report favorably thereon, and recommend that said proposed road be established as a county road and be declared a public highway of Union County, Oregon, and all the proceedings herein having been regular and according to law, and no remonstrance or claim for damages having been filed herein, and there having been no cause shown why this proposed road should not be declared a public highway and ordered open according to law, and the court being satisfied from the report of the Board of County Road Viewers that such road will be of public utility; the report of the viewers being favorable thereto, and all the files and records of said proceedings having been submitted to the District Attorney, who has advised this court as to the legality of said proceedings.

It is therefore CONSIDERED and ORDERED by the court that the report of the Board of County Road Viewers be placed on record in this journal, and that the surveyor's profile and plat of the proposed road, and his field-notes of the survey thereof be placed on record in the Book of Plats of County Roads of Union County, Oregon, and that said proposed road be

SECOND JUDICIAL DAY.

THURSDAY, AUGUST 7th, 1913.

declared a public highway of Union County, Oregon, and ordered opened up and placed in repair for travel according to law, upon the payment into court by the petitioners of the expense of opening the road and the damages, and that _____ Road Supervisor of Road District No. 4, the same being the road district in which said road is located, be furnished with a copy of the petition herein, and a copy of this decree and ordered to open up said road and place the same in repair for travel, upon the payment into court of the expenses of opening the road and damages.

In the matter of the proposed County road petitioned for by H. Rettig et al.

Now at this time it is ORDERED that this matter be, and the same is hereby continued for the term.

In the matter of the approval of Widow's Pensions.

Now at this time is presented to the court orders of the Juvenile Court of this County, awarding Widow's Pensions to Mrs. Luella Castle in the sum of \$10.00; Mrs. Lena Groupe in the sum of \$17.50; Mrs. Lou Dawson in the sum of \$10.00; Mrs. Damietta Kindred in the sum of \$3.35; Mrs. Myrtle Logan in the sum of \$20.50; Mrs. Sarah A. Simpson in the sum of \$7.50; and it appearing to the court that in accordance with the provisions of the "Widow's Pension La2" that this court shall direct warrants to issue in accordance with such orders,

It is therefore CONSIDERED and ORDERED that the County Clerk be, and he is hereby authorized and directed to issue warrants on the General Fund of the County to the persons and in the amounts as above set forth, each month until the further orders of the court.

In the matter of the application for county aid for Mrs. Wallace.

Now at this time this matter came on for hearing upon the application of Mrs. Grace W. Foye for county aid for Mrs. Wallace; and it appearing to the court that Mrs. Wallace is a county charge and is incapable of supporting herself and has no friends or relatives who are willing or able to care for her, and that she is now at the hotel in care of Mrs. Grace Goye at Medical Springs, and that an allowance should be made for her support.

It is therefore CONSIDERED and ORDERED that said application be granted and that the Clerk of this court be and he is hereby authorized and directed to draw a warrant on the General Fund of the county for the sum of \$15.00 per month, monthly in favor of Mrs. Grace W. Foye, to be used in caring for Mrs. Wallace, until the further orders of this court.