

1888

May 17 Petition rec Viewed aff'd
Journal D p 339

July 5 Dismissed
Journal D p 371

304

Road

Beginning about 300 yards E of Sabin
House in S W⁺ of NW⁺ Sec 22 T 4 S R 40 E
to stake marked No 3 about 80 rods N of S E cor
Sec 36 T 4 S R 40 E

304

Petition for County Road.

TO THE HONORABLE COUNTY COURT FOR UNION COUNTY OREGON

The undersigned householders of Union County Oregon residing in the vicinity where the hereinafter described road is proposed to be respectfully petition your Honorable body to lay out and establish a County road within said County on the following line or route to wit

Beginning at a stake marked No. 1 on the County road at the Sta Bruff farm, about three hundred yards east of the Sta Bruff dwelling house, where the old road turns south and crosses the creek, and goes in a south easterly direction up what is known as the Mung gulch, keeping on the east side of said gulch to the farm of Geo W Chimmans, passing through said farm in nearly the same direction, going between the house and stable of said Geo W Chimmans, to the west line of Sec 26, T4 S R40 E 11th. Thence south on said line to a stake marked No. 2, near the southwest corner of said Sec. Thence in a south easterly direction on the most practicable route and terminating at a stake marked No. 3, about eighty rods east of the southwest corner of Sec. 36, T4 S R40 E 11th.

And in duty bound your petitioners will ever pray &c

NAMES

NAMES

D B Rees
 E C Prumard
 J H Crawford
 W H Huffman
 John Collins
 Geo W Stafford
 W H Knight
 J H White
 J O P Jay
 A H Day
 John S. Elliott
 Saml. Ames

Wm Wilson
 E. Hamaker
 A J Goodbrod
 J. Pitt
 John J. J. J.
 A W Benson
 Geo F Hall
 J. M. M.
 A. M. M.

H. Porter
 Geo W. W.
 Thomas Heritage
 W. F. L.
 William Murray
 B. L. Lathrop
 H. Austin
 A. L. Lathrop
 A. W. L.

J. H. Watson
 N. Schommer
 C. E. Rabins
 J. B. Eaton Jr
 J. T. Cockell
 Joseph Stone
 George W. Chimmans

Filed, May 10, 1888

Wm. Neill Clerk
Dy. Oliver Depty

Notice of Road Petition

To all Persons Concerned You and each and all of you will take notice that the undersigned householders for Union County Oregon, residing in the county where the hereinafter described road is proposed to be will, at the next session of the County Court for Union County, Oregon to wit On Wednesday the 16 day of May 1887, respectfully present to said Court a petition praying said Court to lay out, alter and establish a County road within said County on the following line or route to wit Beginning at a stake marked No. 1 on the County road at the LaBueff farm about three hundred yards east of the LaBueff dwelling house, where the old road turns south and crosses the creek, and goes in a south easterly direction up what is known as the Miner gulch occupying on the east side of said gulch the farm of Geo. W. Harmon, passing through said farm in nearly the same direction going between the house on the north of said Geo. W. Harmon to the west line of Sec 26, T. 4, R. 40 N.M., thence south on said line at stake marked No. 2, near the south west corner of said Sec. Thence in a south easterly direction on the most practicable route and terminating at a stake marked No. 3, about eighty rods west of the south ^{East} corner of Sec 36 T. 4 R. 40 N.M.

- | | |
|-----------------|------------------|
| D. H. Lucas | |
| E. L. Brown | |
| W. H. Bradford | A. J. Goodbrod |
| W. H. Haffner | John J. Irving |
| John Dolbin | |
| | P. W. Benson |
| | Geo. J. Ball |
| J. A. White | J. J. Williamson |
| O. P. Fay | A. G. Neils |
| E. H. Day | |
| John S. Elliott | N. Schoonover |
| Geo. W. Moore | E. Rabins |
| W. H. Porter | J. B. Eaton Jr. |
| Geo. H. Harris | A. Cockell |
| Thomas Heritage | Joseph Fore |
| H. P. Stead | Geny W. Simmons |
| William Murray | B. F. Lathrop |
| Wm. Austin | A. L. Lathrop |

Filed May 16th 1878
Asst. Meek clerk
B. J. Thomas Deputy

Notice of Road Petition

To All Persons Concerned; You, and each and all of you, will take notice that the undersigned, householders for Union County, Oregon, residing in the vicinity where the hereinafter described road is proposed to be, will, at the next session of the County Court for Union County, Oregon to-wit: On Wednesday, the 16 day of May, 1888, respectfully present to said Court a petition praying said Court to lay out and establish a County road within said County on the following line or route, to-wit: Beginning at a stake marked $N^{\circ} 1$ on the County road at the Salineff farm, about three hundred yards east of the Salineff dwelling house, where the old road turns south and crosses the creek and goes in a south easterly direction up what is known as the Denny gulch keeping on the east side of said gulch to the farm of G. W. Simmons, passing through said farm in nearly the same direction, going between the house and stable of said G. W. Simmons to the west line of Sec 26 T4 S R 40 E 1/4. Thence south on said line to a stake marked $N^{\circ} 2$ near the southwest corner of said Sec. Thence in a south easterly direction on the most practicable route and terminating at a stake marked $N^{\circ} 3$ about eighty yards west of the south west corner of Sec 86 T4 S R 40 E 1/4.

- | | |
|---|---|
| <p> D. B. Beez
 E. C. Bernard
 J. H. Crawford
 W. H. Huffman
 John Dobbin
 Geo. W. Stafford
 A. B. Reinhardt
 M. Lucklin
 A. H. White
 O. P. Jazroy
 C. H. Day
 John S. Elliot
 Geo. W. Ames
 W. H. Posten
 George W. Ward
 Thomas Heritage
 H. P. Stewart
 Wm. Murray
 B. J. Shelton
 Wm. E. Wash
 A. J. Sathrop
 A. S. McCorme </p> | <p> Wm. Wilson
 E. R. Rumlaid
 A. J. Goodroad
 J. W. Shelton
 John Peely
 W. Sherman
 A. M. Benson
 Geo. F. Bell
 J. T. Williamson
 A. J. Peck
 J. B. Johnson
 J. H. Wasson
 M. Schommer
 C. E. Robbins
 J. B. Eaton Jr.
 A. Cochril
 Joseph Sore
 George W. Simmons </p> |
|---|---|

1888

Filed May 16 1888
in the clerk
of the District

May 17 1888
Deceased John Schindler
to the Clerk of the District
Santiago P. de la Cruz
met at the St. Anthony place
on May 10 at 10 am

I George W. Ames being first duly sworn, say that I posted three several notices of which the notice hereto attached is a true and correct copy, in three public places in said County in the vicinity of the proposed road therein described, to-wit: One at each end of the proposed road and one near the middle of the proposed road. The one at the termination of the road I mailed & posted on Mr Lathrop's farm and the other two are on boards nailed to the fence, and all are plain to be seen and in public places.

Thirty days previous to the presentation of the road petition therein mentioned, to-wit: On the 14th day of April 1888, and that thereafter and thirty days previous to the presentation of said road petition therein mentioned, to-wit: on the same day of April 1888, I posted a true and correct copy of said notice at the place of holding Court for Union County, Oregon, to-wit: On the front of the Court House door, in the town of Union, in said County, and that said notices remained posted thirty days previous to the presentation of said petition as I verily believe.

Geo. W. Ames

Subscribed and sworn to before me this 16th day of May 1888

A. W. Neill, Clerk
By James Oliver, Dep.

Filed May 6 "1868

A. J. Hill clerk

By J. Robinson Depy

Know all Men by these Presents:

THAT WE, George W. Ames and
of the County of Union

and State of Oregon, are held and firmly bound unto the said County of Union in
the sum of One Hundred Dollars, the payment of which, well and

truly to be made, we bind ourselves, our heirs, executors and administrators, firmly by these presents.

Signed this 16 day of May 1888

Now the condition of the above obligation is such, that whereas, if the County Road petitioned for by J. B. Rees and others, and presented at the May

Term, 1888 of the County Court of said Union County, commencing at a stake marked No. 1 on the County road at the LaBuff farm, about 300 yds East of the LaBuff house in S.W. 1/4 of NW 1/4 Sec 22 T41R 39E W.M., where the old road turns South and crosses the creek thence S.E. up what is known as the Merry Gulch, keeping on the East side of said gulch to the farm of Geo. W. Simmons, passing behind the house and stable of Geo. W. Simmons to the Meach house of Sec 26 T41R 39E W.M. thence South on a grid line to a stake marked No. 2 near the SW corner of said Sec. Thence in a South Easterly direction on the most practicable route and termination of a stake marked No. 3 about 300 yds West of the corner of Sec 26 T41R 39E W.M. If said roads be located and established, then this obligation to be void, otherwise to remain in full force and virtue in law.

Geo. W. Ames

STATE OF OREGON,

County of Union } ss.

I Geo. W. Ames and

each for himself say that I am worth the sum of

Two Hundred Dollars over and above all debts and liabilities and property exempt

from execution, and that I am a resident and householder in said County and State.

Geo. W. Ames

Subscribed and sworn to before me, this 16 day of May A. D. 1888

A. S. Neill Clerk,

By Turner Oliver Deputy.

Bond of Road Petitioners.

D. B. Rees et al

Petitioners.

Filed *May 16* 188*8*

A. M. Neill

County Clerk.

By *Turner Oliver*

Deputy.

REPORT OF VIEWERS.



TO THE HONORABLE COUNTY COURT FOR UNION COUNTY, OREGON:

The undersigned viewers heretofore on the 17 day of May, 1888, appointed to view and lay out and alter the proposed County road, of which the survey hereto attached is a true and correct description, as petitioned for by A. B. Rees, et al, beg leave to report that on the 28th day of May, 1888, in pursuance with said appointment and order, after being duly sworn to faithfully and impartially discharge the duties of said appointment, we proceeded to view out said proposed road for the whole distance thereof, and that in our opinion said proposed road should not be laid out - or - established as a public highway of UNION COUNTY, OREGON. That the same is not practicable and would not add to the convenience of the householders residing in the vicinity thereof, we therefore recommend that said proposed road be not laid out nor declared a public highway of said county.

John Haynes
A. L. Cook

John R. Johnson

Filed June 4. 1888
O. J. Mills
Clerk

Plat of Proposed County Road of D. B. Reese and Others in T. 4. S. R. 40. E. 200m

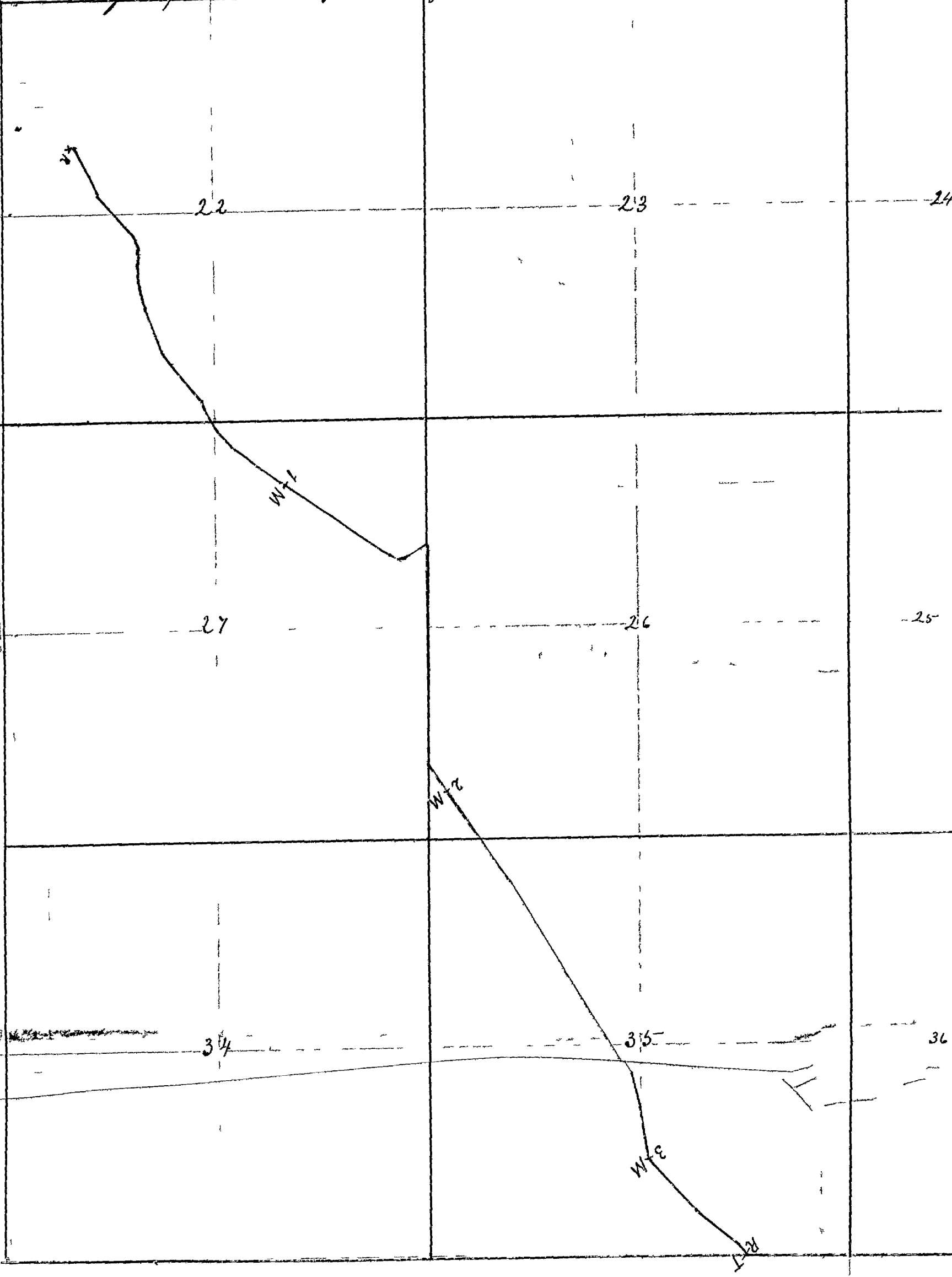

22

23

24

W-1

27

26

25

W-2

34

35

36

W-3

RT

Field Notes of the Survey of the Proposed County Road of J. B. Reese, and others

I started at a point on the County Road near the La Buff House on the S.W. 1/4 N.W. 1/4, Sec. 22, T. 4. S. R. 40. E. W. M. by planting a Stone marked R as by Law required. from which I run East 2 Rods to State A. 1.

Thence S 26° E 40 Rods to A. 2

" S 42° E 42 " " A. 3

" S 23° E 12 " " A. 4

" S 1° E 28 " " A. 5

" S 18° E 24 " " A. 6

" S 23° E 34 " " A. 7

" S 36° E 22 " " A. 8

" S 41° 30' E 24 " " A. 9

" S 20° 30' E 12 " " A. 10

" S 28° 45' E 16 " " A. 11

" S 42° 15' E 20 " " A. 12

" S 52° 30' E 20 " " A. 13

" S 55° E 24 Rods to

a Stone marked 1. M.

Thence S 55° E 94 Rods to A. 14.

" S 68° 15' E 8 " " A. 15

" N 89° 15' E 8 " " A. 16

" N 58° E 25 " " A. 17

" South 163 1/2 " " A. 18

" S 34° E 21 1/2 " " A. 19

a Stone marked 2. M.

Thence S 35° 45' E 84 Rods to A. 20

" S 35° 30' E 176 " " A. 21

" S 22° 30' E 20 " " A. 22

" S 19° E 40 " " A. 23

a Stone marked 3. M.

Thence S 44° E 56 Rods to A. 24.

" S 51° E 34 " " A. 25

" S 41° E 11 a Stone marked

R. T. ^{State marked No. 8.} as by Law required, and

situated 80 Rods West of the

S. W. Corner of Sec. 36. in

T. 4. S. R. 40. E. W. M.

in Place of the S. E. Corner of

said Section, G. W. Ames

the Bondsman being Present and explained

that there was a Misdescription in

the order of the Court as to the

Ending Point J. W. Kimbrell

Deputy Co Surveyor

May 28 1868

Filed June 6. 1888
O. G. M. W. B.
Clerk

Second Judicial Day

Thursday May 11th 1888

householders living in the vicinity of said proposed road that a good and sufficient undertaking has been filed herein and no remonstrance having been filed or cause shown why such road should not be viewed and surveyed according to Law It is therefore considered and ordered that Samuel Galloway, William Stiker and John Haines be appointed Viewers and J. N. Kimbrell Surveyor to view, survey and layout said proposed road and that they meet at the beginning of said proposed road on Wednesday May 30th 1888 ^{at 9 o'clock AM} and duly qualify before they proceed with their duty on this behalf.

In the Matter of the
County Road petitioned
for by D. B. Rees et al

At this time is presented to the court the petition of D. B. Rees and 39 others praying for the establishment of a county road as follows, to wit: - Beginning at a stake marked No 1 on the County Road at the LaBuff farm, about 300 rods East of the LaBuff dwelling house in S. 1/4 of T. 11ⁿ. Sec 22 T. 4 R. 40 E. 11^m. where the old road turns South and crosses the creek, and goes in a South Easterly direction up what is known as the Murray Gulch, keeping on the East side of said gulch to the farm of Geo. M. Simmons, passing through said farm in nearly the same direction, going between the house and stable of said Geo. M. Simmons to the West line of Sec 26 T. 4 R. 40 E. 11^m. Thence South on said line to a stake marked No 2 near the South West corner of said Sec. Thence in a South Easterly direction on the most practicable route and terminating at a stake marked No 3 about 80 rods West of S.E. Corner of Sec 36 T. 4 R. 40 E. 11^m. and it appearing to the court from proof filed herein that due and legal notice of the pendency of this proceeding has been given, that more than twelve of said petitioners are legal householders living in the vicinity of said proposed road and that a good and sufficient undertaking has been filed herein and no remonstrance having been filed herein or cause shown why said petition be not granted, It is considered and ordered by the court that John Johnson, A. B. Cook and John Haines be appointed Viewers and J. N. Kimbrell surveyor to view and survey said proposed road, and that they meet at the old LaBuff place on Monday May 28th 1888 at 10 o'clock AM and duly qualify before they proceed with their duty on this behalf.

Christ Judicial Day

Thursday July 5th 1888

In the matter of the }
 proposed County road }
 petitioned for by D. G. }
 Chandler et al.

This matter came on to be heard upon the reports of the viewers and surveyor herein and the said reports having been read in open court for the first time are laid over for a second reading on some other day of this term.

In the matter of the proposed }
 County Road petitioned for }
 by D. B. Rees et al.

This matter came on to be heard upon the report of the Viewers and surveyor herein, and said reports having been read in open court, and it appearing to the Court that the Viewers report unfavorable on said proposed road and recommend that the road be not opened or declared a public highway. It is considered and ordered by the Court that all further proceedings herein be dismissed and that all costs incurred by the County herein be taxed up to the petitioners herein, to wit the sum of \$34.²⁰/₁₀₀ and that the sureties on the undertaking herein be notified to pay such sum to the County Treasurer and produce and file with the Clerk the Treasurers receipt for the same.

In the matter of the proposed }
 County Road petitioned for by }
 Nathan Nelson et al. No. 1

This matter came on to be heard at this time upon the reports of the viewers and surveyor hitherto appointed herein and said reports are read in open court for the first time, and it further appearing that a claim for damages has been filed herein and also a Remonstrance by G. W. & M. P. Ames, and the Court having duly considered said remonstrance and being well advised herein It is ordered that said Remonstrance be overruled and denied, and in regard to the petition of G. W. & M. P. Ames for damages herein It is ordered that John Dobbin, Robt. Shaw and D. W. Johnson be appointed appraisers to view the premises of petitioners the whole distance through which the said proposed road passes and report to the Court how much less valuable said premises will be rendered on account of the construction of said proposed road