

No 5 Equity  
in  
Circuit Court

Jesse M Roberts

Plaintiff

vs

Nathan L Roberts

Defendant

Action for Divorce

Docket

Page

O F Bell

Attorney for Plaintiff

Attorney for Defendant

REVENUE AND GENERAL TAXES  
PAID BY THE TAXPAYER  
IN FULL OF ALL TAXES  
DUE ON THIS PROPERTY  
FOR THE YEAR 1901

**Record of the Case**

174

**WITNESSES.**

1882

June 12 Petition rec Viewers appld  
 Journal B p 718

July 6 1st reading report  
 Journal B p 731

July 7 ordered app. ends  
 Journal B p 735

○ Road ○

Beginning at Sturgell School House  
 in West # 34 to S E cor of 20<sup>th</sup> Sec 10  
 T 1 S R 43 E

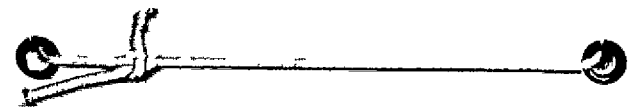

**DIRECTIONS**—Place papers on TOP OF RUBBER  
 Fold ends first then sides Throw the rubber cords  
 over the ends and package is complete

174

Lostine Union Co Oregon  
Mar 24<sup>th</sup> 1882

Willis Skiff Co Clk  
Dear Sir

Enclosed please find  
notice for county road, will you kindly  
post on court House door, You will  
find affidavit as regards posting notices  
at bottom of the petition which I also  
enclose. The proposed road is an  
important and much needed one  
and if the county court grants our  
petition would suggest as reviewers J H Mc Cubbin  
M Boutwell and J A Hunter, all  
addressed at Lostine and place of  
meeting = Sturgill School House R. L. Erwin

Nov 24<sup>th</sup> 1882

FIRST CLASS

To the Hon County Court of Union County Oregon

We the undersigned citizens of the above named county and state, would respectfully petition your honorable body, to locate and establish a county road described as follows =

Beginning at what is known as the Sturgill School House in District No 34 Union County, Oregon - running thence south 1/4 of a mile thence east 1/2 mile, thence south 3/4 of a mile, thence east 3/4 of a mile, thence south 1 3/4 miles, thence east 1/2 mile, thence south 1/2 mile, thence east 1/4 mile, thence south 1/4 mile, thence east 1/2 mile, thence south about thirty five rods, thence in a southeasterly direction about 1/4 of a mile on the most practicable route to Lostine, thence east to the south east corner of the south west 1/4 of sections 10, Township 1 south, of Range 43 east, all in Union County Oregon - and we your petitioners well wish pray

O. A. Bishop	R. L. Erwin	John B. Faust
A. S. Tully		Sam. B. Willett
Geo. W. Richardson		J. B. Willett
W. J. Richardson		George Patrick

J. A. Hann	J. L. Hann
W. Masters	J. L. Post
R. A. Masterson	Thos. H. Post
K. Meader	Geo. A. Kendall
P. H. Halley	Joe. Foley
Geo. J. Bowman	L. W. Workman
W. B. Fisher	J. C. Post
J. M. Anderson	Wm. Buffington

Personally appeared before the undersigned a justice of the peace in and the precinct of Wallawa, county of Union and State of Oregon, R. L. Erwin who being first duly sworn make affidavit that he has this day posted notices of above county road fully describing the same as follows - viz one at the beginning of proposed road, one at the Lostine and vice 1 1/2 miles from Lostine on proposed road

R. L. Erwin

Subscribed and sworn to before me this 24<sup>th</sup> day of March 1882 J. A. Hunter Justice of the Peace

Frank P. Johnson

March 29<sup>th</sup>

1882

Wells - Wash.

Co. Wash.

Project under way  
Bands to be added

To Whom it may concern

March 24<sup>th</sup> 1882

Notice is hereby given that there will be a petition presented to the county court of Union County Oregon at the regular meeting in May 1882 to locate and establish a county road in Union County, Oregon, described as follows = Beginning at what is known as the Sturgill School House in district No 34 Union County Oregon running thence south  $\frac{1}{4}$  mile, thence east  $\frac{1}{2}$  mile, thence south  $\frac{3}{4}$  miles, thence east  $\frac{3}{4}$  miles, thence south  $1\frac{3}{4}$  miles, thence east  $\frac{1}{2}$  mile, thence south  $\frac{1}{2}$  mile, thence east  $\frac{1}{4}$  mile, thence south  $\frac{1}{4}$  mile, thence east  $\frac{1}{2}$  mile thence south about 35 rods thence in a southeasterly direction about  $\frac{1}{4}$  of a mile on the most practicable route to Lostine, thence east to the south east corner of the south west  $\frac{1}{4}$  of section 10, Township 1 south, Range 43 east all in Union County, Oregon

O. N. Bishop  
 R. L. Ewin  
 A. S. Tully  
 A. M. Alexander  
 A. N. Richardson  
 W. J. Richardson

John B. Dent  
 Saml B. Willett  
 J. S. Willett  
 G. B. Jacob  
 George Pickett

J. H. Hann  
 Wm Masterson  
 R. W. Masterson  
 J. L. Reader  
 J. S. Hally  
 Geo. J. Bowman  
 B. Perkins  
 Richardson

J. H. Hann  
 G. L. Post  
 Wm H. Post  
 Geo E. Kendall  
 Joe Foley  
 L. W. Womack  
 Wm H. Buffington  
 T. R. Cook

Willis Duff March 24<sup>th</sup> 1882

State of Oregon }  
Union County } I Jas. A Hunter  
being duly sworn say that three  
of the within notices were posted  
in three public places in the  
district ~~near~~ vicinity of the  
within proposed road more  
than thirty days prior to the date  
hereof.

Subscribed and sworn to before me this 23  
day of May 1882 }  
Willis Shuff }  
of Ed & Bates Dry Clerk }  
Board Notice

State of Oregon }  
County of Union } I Willis Shuff being  
first duly sworn say that I posted the  
within notice on the court house door in  
Union, Union County, Oregon on the 31<sup>st</sup>  
day of March 1882 and more than 30 days  
prior to the date of the presentation of the  
petition herein. Willis Shuff

Subscribed and sworn to before  
me this 12<sup>th</sup> day of June A D 1882  
A. C. Craig  
County Judge

Filed June 12  
1882  
Willis Shuff  
Clerk

**Know all Men by these Presents:**

THAT ~~we~~ *Jas A Hunter* ~~and~~ *Ureir*

~~and~~ *Ureir*, of the County of ~~Marion~~ *Ureir* and State of Oregon, are held and firmly bound unto the said County of ~~Marion~~ in the sum of *Twenty Five* Dollars, the payment of which, well and truly to be made, ~~we~~ *I* ~~bind ourselves, our heirs,~~ *submit my* executors and administrators firmly by these presents.

Signed this *23* day of *May* A. D. 18*82*

Now the condition of the above obligation is such, that whereas, if the County Road petitioned for by *R D Crovin* and others, and presented

at the *July* term, 18*82* of the County Court of said ~~Marion~~ *Ureir* county, commencing ~~at what is known as the Sturgill School house in Dist. No 34 Union Co Or.~~ *at what is known as the Sturgill School house in Dist. No 34 Union Co Or. thence Sore 1/4 mile thence E 1/2 mile thence S 3/4 mile thence E 3/4 mile thence S 1/4 mile thence East 1/2 thence S 1/2 mile thence E 1/4 mile thence S 1/4 thence E 1/2 thence South about 35 rods thence in Southeast direction about 1/4 mile on its most practicable route to Pasture thence East to the South East Corner of the NW 1/4 of S 10 T 1 R 43 East*

be located and established, then this obligation to be void; otherwise to remain in full force and virtue in law.

*Jas A Hunter*

**STATE OF OREGON,**  
**COUNTY OF MARION,** } ss.

I, ..... and

..... each for himself says that I am worth the sum of ..... Hundred Dollars over and above all debts and liabilities and property exempt from execution, and that I am a resident and householder in said County and State.

Subscribed and sworn to before me, this.....

day of..... A. D. 187

Clerk.



How all Men of these Presents:

Recd June 12. 1882  
Miss's Shop  
Bo-Bo-Bo

STATE OF OREGON

County of Marion

Subscribed and sworn to before me this 12th day of June 1882

To the Hon. County Court of  
Union County, Oregon

We the undersigned, viewers  
appointed by your Honorable  
Body to view out a proposed  
county road from the Sturgill  
school-house to Lostine  
submit the following report  
in relation thereto. We met  
on the 26<sup>th</sup> day of June A.D. 1882  
as mentioned in your order  
the three viewers being present  
and after being first duly sworn  
in company with the surveyor  
proceeded to view, survey and  
lay-out said road as described  
in your order and as shown  
by the surveyor's plat and report  
submitted herewith.

We find the road to be located  
on as good ground as the section  
of country over which the road  
is laid will admit of and  
taking into consideration the  
necessity that exists for a  
direct road from the Sturgill  
school-house to Lostine we  
recommend that said route  
be established as a county road

Viewers of  
proposed Co Road

D. K. Francis  
J. H. McCallister  
M. B. Boatman

Report of Survey, to the Viewers  
of a proposed County road from  
the Sturgeon school-house in Dist  
N<sup>o</sup> 34 to Lostine

The following are the field notes  
Beginning at a post marked R and  
mound placed on the East side of  
the County road opposite the above named  
school-house

1/4	South	80 rods	to post	marked	AI.
"	East	160 "	"	"	AII.
"	South	240 "	"	"	AIII.
"	East	240 "	"	"	AIV.
"	South	560 "	"	" mound "	AV. 4 M
"	East	160 "	"	"	AVI.
"	South	80 "	"	"	AVII.
"	East	160 "	"	"	AVIII.
"	South	160 "	"	"	AX.
"	East	80 "	"	" mound "	AXI. 6 M
"	South	30 "	"	"	AXII.
"	East	30 "	"	"	AXIII.
"	N 40° E	10 "	"	"	AXIV.
"	East	20 "	"	"	AXV.
"	S 30° E	30 "	"	"	AXVI.
"	East	12 "	"	"	AXVII.
"	South	38 "	"	"	AXVIII.
"	East	64 "	"	" mound "	RT - terminating

at the S E cor of the S W 1/4 Sec 10 T 18. Range 403 East  
State of Oregon } ss  
County of Union }

I Eugene Chase County Surveyor in  
and for the County and State aforesaid do hereby certify  
that the field notes of the survey of the above described  
road are correct as surveyed by me under the  
supervision of the viewers on the 26<sup>th</sup> day  
of June 1882.

Eugene Chase Co Surveyor

Survey of County Road from Sturgill  
School-house in Dist N<sup>o</sup> 34, to Lostine

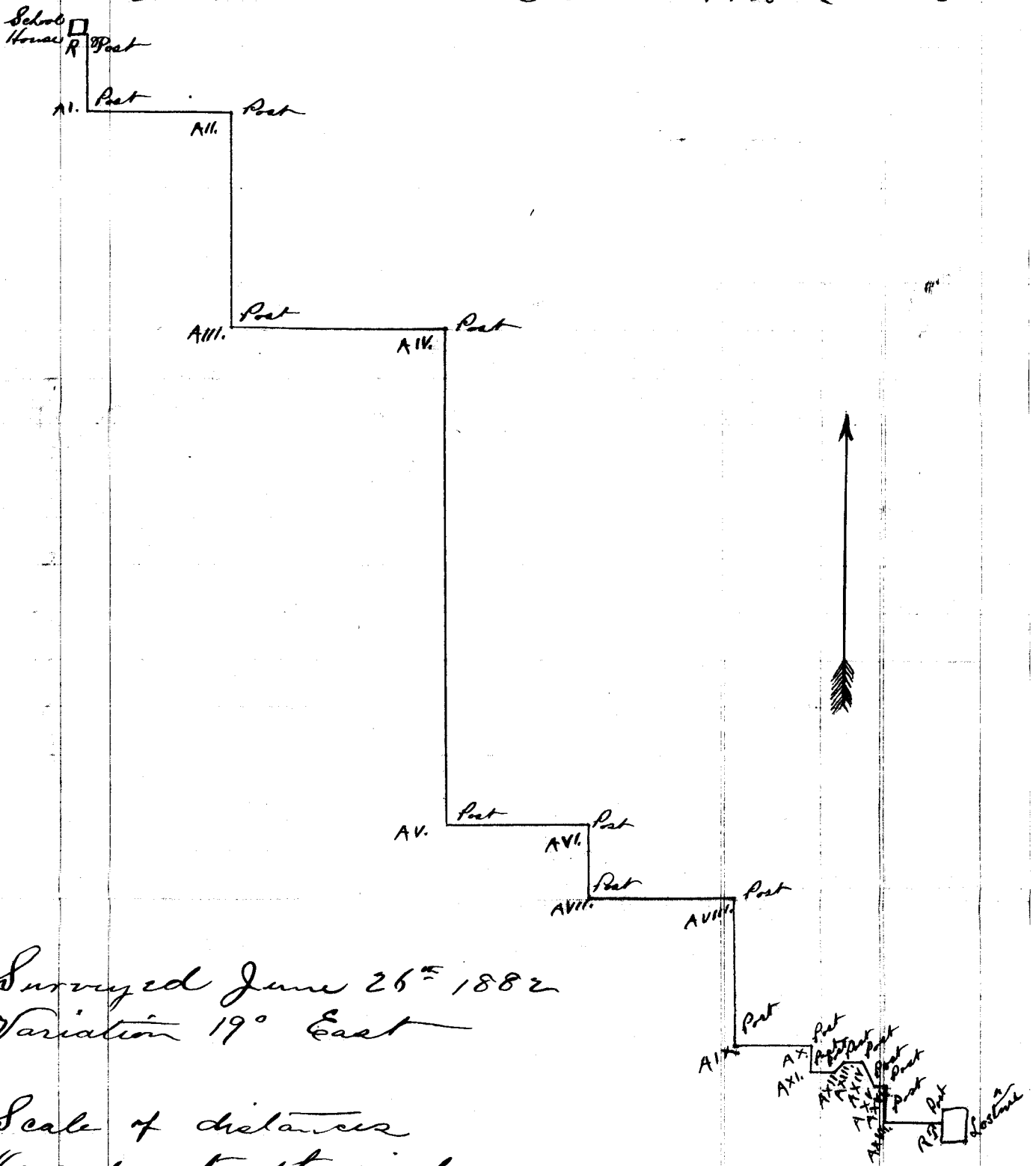

Surveyed June 26<sup>th</sup> 1882  
Variation 19° East

Scale of distances  
160 rods to the inch

Whole distance  
6 miles - 204 rods

Survey of County Road  
from

Highway School - Run

A. S. ...

Filed July 5, 1882

W. S. King

Clerk

At a regular Term of the County Commissioners Court began and held at the Court House in the Union Union County Oregon on the 12<sup>th</sup> day of June A.D. 1872, there was present Hon. S. C. Craig Judge, S. W. Saunders Commissioner, Willis Stiff Clerk and R. J. Rogers Sheriff.

Due proclamation of the opening of Court having been made, the following proceedings were had to wit:

In the matter of petition for a County Road near Lostine

On this day came C. S. Erwin who presents to the Court the petition of himself and more than 12 others praying the location and establishment of a County Road as follows, to wit: Beginning at what is known as the Sturgis School House in District No 34 thence South  $\frac{1}{4}$  of mile; thence East  $\frac{1}{2}$  mile; thence South  $\frac{3}{4}$  of mile; thence East  $\frac{3}{4}$  mile; thence South  $1\frac{1}{4}$  miles; thence East  $\frac{1}{2}$  mile; thence South about thirty five rods; thence in a southeasterly direction about  $\frac{1}{4}$  mile on the most practicable route to Lostine; thence East to the South East Corner of the South west  $\frac{1}{4}$  of Sec 10 T. 1. S. R. 43. E. And it satisfactorily appearing to the Court from proof filed herein that due notice of the pendency of this proceeding has been given as by law required; that more than twelve of said petitioners are legal householders residing in the vicinity of said road and that a good and sufficient bond has been filed. It is therefore ordered by the Court that John M. Gibson, W. Douthett and J. H. Francis be appointed viewers and Eugene Chase Surveyor, to view survey and report upon said proposed

road and that they meet at the Sturgis School house on the 26<sup>th</sup> day of June 1882 and duly qualify before entering upon the discharge of their duties in this behalf.

In the matter of location of  
and establishment of proposed  
County Roads.

On this day came James Ogarth, who presents to the Court the petition of himself and 22 others praying the location and establishment of a County Road as follows, to wit: Beginning  $\frac{1}{4}$  of a mile south of James York's dwelling house on the County Road leading from C. Hagen via Wolf Creek to North Powder River thence East  $\frac{3}{4}$  of a mile; thence South  $\frac{1}{4}$  of a mile, thence East until it intersects the County Road leading from La Grande via Ladd Canyon to North Powder mills and it satisfactorily appearing to the Court, from proof filed herein, that due notice of the pendency of this proceeding has been given as by law required; that more than twelve of said petitioners are legal landholders residing in the vicinity of said Road, and that a good and sufficient bond has been filed. It is therefore ordered by the Court that Augustus Lites, John Bryant and W. H. Halbrook be appointed viewers and Eugene Chase Surveyor, to view, survey and report upon said proposed County Road and that they meet at the house of James York on the 19<sup>th</sup> day of June 1882 and duly qualify before entering upon the discharge of their duties in this behalf.

In the matter of the }  
 qualifications of }  
 R. J. Rogers - Sheriff }

Now at this time comes R. J. Rogers and presents to the Court his certificate of Election as Sheriff of Union County Oregon together with his oath of office and official Undertaking as such Sheriff - and the Court upon examination there of find the qualifications herein filed to be such as the law requires. It is hereby ordered that said undertaking be and the same is hereby approved. -

In the matter of Views }  
 report on proposed County }  
 Road petitioned for by } 1<sup>st</sup> Reading  
 O. A. Bishop et al }

Now at this time was read the first time the views report on a proposed County Road from what is known as the Sturgill School House to Lostine in the Willow Valley upon which the same was continued until tomorrow for further consideration. -

Thereupon the Court adjourned until Tomorrow Morning at 8. O. Clock



prayed for therein. Therefore it is ordered that the boundaries between said Districts No. 13 & 20 shall be the summit of the Mountain between Pine and Eagle Valleys. —

In the matter of levity }  
 Road petitioned for by }  
 O. N. Bishop et al. }  
 ✓

Now at this time is read the Viewers report on a proposed County Road petitioned for by O. N. Bishop and others and said report being favorable and having been read on two different days of this term of Court and it appearing to the satisfaction of the Court that the proceedings herein have been regular and according to law and there being no remonstrance or bills for damage filed herein — it is therefore ordered that said viewers report and plat of the Surveyor be placed on record and that said road be established as a County Road and opened according to law. —  
 Viewers Report }  
 }

To the Hon. County Court of Union County Oregon: —

The undersigned viewers appointed by your Honorable Body to view out a proposed <sup>County</sup> road from the Sturgill school house to Lostine submit the following report in relation thereto. We met on the 26<sup>th</sup> day of June A. D. 1882 as mentioned in your order the three viewers being present and after being first duly sworn, in Company with the Surveyor proceeded to view and lay out said road as described in your order and as shown by the Surveyors plat and report submitted herewith. We find the road to be located on as good ground as the section of country over which the road is laid will admit of and taking into consideration the necessity that exists for a direct road from the Sturgill school house to Lostine we recommend that said route be established as a

Survey,

Leimity road.

Viewers of  
Proposed C Road

3 J. W. Francis  
3 J. H. McCubbin  
3 M. H. Boatman

Report of Surveyor to the Viewers  
of a proposed Leimity Road from  
The Sturgill School house in Dist.  
No. 34 to Lostine.

The following are the field notes. Beginning at  
a post marked R. and mound placed on the  
East side of the Leimity Road opposite the above  
named School House. -

Thence -	South	80	Post <sup>to P</sup>	Post	marked	A I
"	East	160	"	"	"	A II
"	South	240	"	"	"	A III
"	East	240	"	"	"	A IV
"	South	560	"	"	" + Mound	A V 4 m
"	East	160	"	"	"	A VI
"	South	80	"	"	"	A VII
"	East	160	"	"	"	A VIII
"	South	160	"	"	"	A IX
"	East	80	"	"	" + Mound	A X 6 m.
"	South	30	"	"	"	A XI
"	East	30	"	"	"	A XII
"	N 40° E	10	"	"	"	A XIII
"	East	20	"	"	"	A XIV
"	S 30° E	30	"	"	"	A XV
"	East	12	"	"	"	A XVI
"	South	38	"	"	"	A XVII
"	East	64	"	"	" + Mound R. T. v	

terminating at the S.E. Cor. of the S.W. 1/4 Sec 10  
T. 1 S. Range 43 East

State of Oregon }  
Leimity of Union } S.S.

I, Eugene Chase, Leimity Surveyor in  
and for the County of said State aforesaid do hereby  
certify that the field notes of the survey of the  
above described road are correct as surveyed  
by me under the supervision of the owners  
on the 26<sup>th</sup> day of June 1882

Eugene Chase  
County Surveyor -

Survey of County Road from Sturgill  
School-house in District No. 34 to Lostine

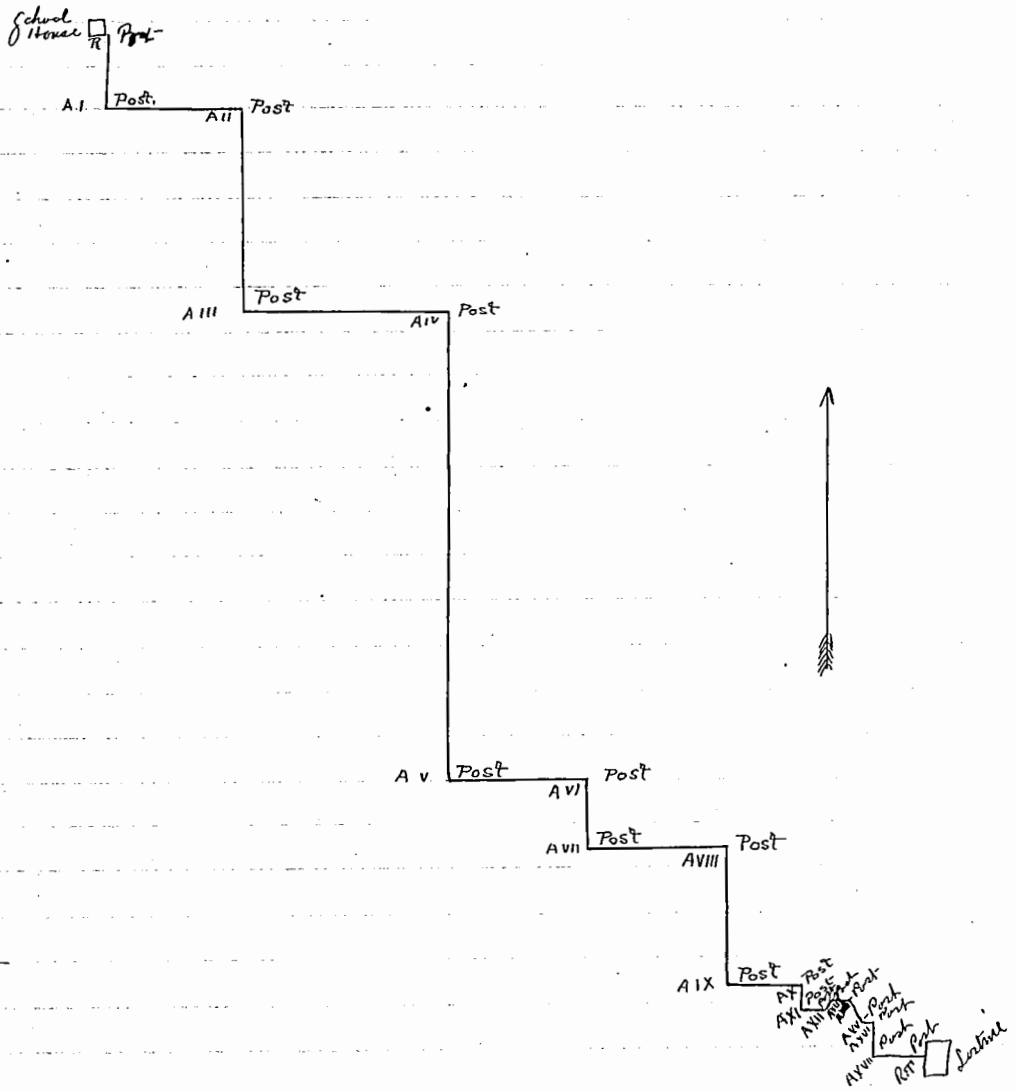

Surveyed June 26<sup>th</sup> 1882  
Variation 19° East

Scale of distance  
160 Rods to the inch

Whole distance  
6 Miles 204 Rods